

21 MAR 69  
"ell B when rest is in  
sight."

~~2000 20 MAR 69~~

~~Harvard~~

~~IIAV~~

From AP to 'B':

Harvard "thrust effect."

20 MAR 69 2000

Harvard FTAD - local shackle.

Spawner IIAV - "

Board Slugs:

From 7 Up

1. R 2.1 U 0.9

2 R 2.0 U 0.7

3 1.8 0.7

4 1.7 0.8

5 1.8 1.0

6 2.0 1.1

Depart 1030 = 500

23 MAR 69

896203 24 MAR 69, Obj. 10.

bird: 88 21 (Spawner)  
eggs: 90 24

lots - B3P - 1945-2000

3 will come 2 our frame  
sometime tonight. On our  
Co. push - "C3"  
we at 1<sup>st</sup> site.

We are a blood force.

Spis from Spawner:

1. L 2.4 U 0.4

2. L 2.0 U 0.1

3. L 1.9 D 0.2

4. L 1.6 D 0.6

5. L 1.3 D 0.9

6. L 0.6 D 1.1

7. L 0.1 D 1.1

8. R 0.4 D 1.0

9. R 0.9 D 1.0

10. R 1.2 D 0.8

21 MAR 69

Yell to when rest is in sight.

~~2000 20 MAR 69~~

~~Harvard~~

~~IIAV~~

From A7 to 'B':

Harvard "thrust effect."

20 MAR 69 2000

Harvard FTAD - local obs

Sparrow IIAV - "

Board Sluggers:

From 7 Up

1, R 2.1 U 0.9

2, R 2.0 U 0.7

3, 1.8 0.7

4, 1.7 0.8

5, 1.8 1.0

6, 2.0 1.1

Depart 1030 = 1500

23 MAR 69

Yell 896203 24 MAR 69, Obj. 10.

Any bird: 88 21 (Sparrow)

Collaps: 90 24

Write notes - B3P - 1945-2000

'C' 3 will come 2 our frame sometime tonight. On our

Co. push - "C3"

Leave at 15<sup>th</sup> Lste.

- We are a block force.

Cps from Sparrow:

1, L 2.4 U 0.4

2, L 2.0 U 0.1

3, L 1.9 D 0.2

4, L 1.6 D 0.6

5, L 1.3 D 0.9

6, L 0.6 D 1.1

7, L 0.1 D 1.1

8, R 0.4 D 1.0

9, R 0.9 D 1.0

10, R 1.2 D 0.8

Moves: 2, 3, CP, 4, 1  
Blue line  $\frac{1}{2}$  hr. out of lines -  
leave full canteena - salt tabs -  
newboys will take.  
Obj. will be prepared by 155's;  
route possibly by air,  
25 mm / plt.

Newboys - tell how to pack,  
links, etc.  
Eat a Long Pat tomorrow ~~with~~  
noon.

23 MAR 69

Pz - 2000 - 0630

B3P - South Finger

B3Z - L side of trail to obj. -  
a squad ambush near  
same trail route, from  
1<sup>ST</sup> PLT.

899 203 - 18 MAR - 3 NVA

" " - 8 "

982 204 - several

Fire disc.

Work on holes - did well site  
after we arrived.

Eating - time for.

Col LaFonde, Lt. Col Kyle send  
outstanding to Bravo.

Will stay several days.

Re-synch tomorrow 4 same.

Day acts - 1<sup>ST</sup> plt patrol - 3rd  
nothing.

Will settle into routines.

Will be going on Co size patrols +  
maybe overites.

Location -

Nite acts - squad ambush from  
1<sup>ST</sup>, LPA & others.

Rotate ~~the~~ patrols, ambushes, etc.  
1<sup>ST</sup> Sq. - new men.

Fires - cigs.

Groups play radio? No.

Small radio? As we want.

26 MAR 69

Platoon - size patrol:

~~0900-1730~~ - 1600 From Bid:

CP 1 - R 1.4 D 0.9

2 R 1.3 D 1.1

3 R 1.3 D 1.3

4 R 1.4 D 1.5

5 R 1.5 D 1.3

6 R 1.7 D 1.1

7 R 1.8 D 0.9

8 R 1.6 D 0.8

Wharst Points

Apacher 8925

Chuckles ~~8223~~ 6223 Candy

Mexas 8620

Woolworth's 9022 ✓

Erie 9324 ✓

Summer 8419

Earth 8818

Porosha 8645

Pacific 9444

Genesee 8847 girl's names

Second pltt. will have ambush at:

When CP 6 R 1.8 D 0.7

Bring in 2nd pltt. on our way  
in.

6-2 + operator w. us.

We sweep toward 2nd - as wide  
as possible.

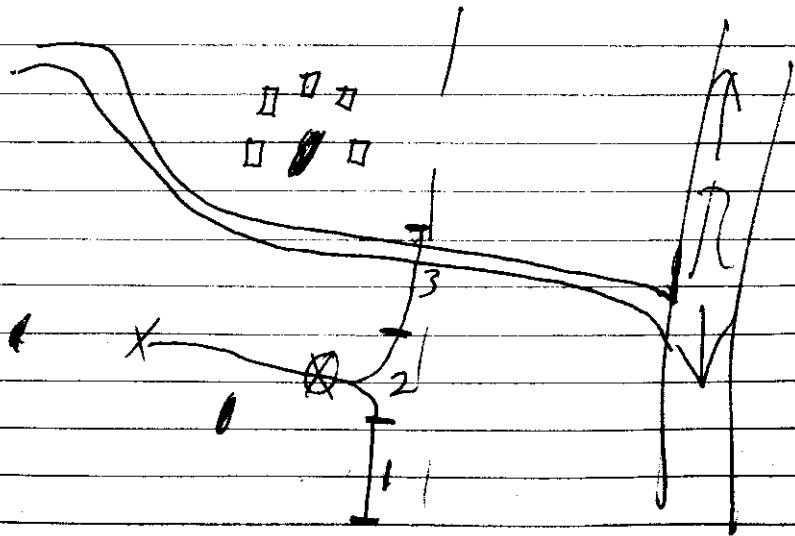

26 MAR 69

~~27 MAR 69~~

~~Patrol~~ ~~ambush~~ stream  
1st Pat. nite amb. 26 MAR 69 897207

26 MAR 69:

2 LP from WW: 1930-0630

BSP: L 0.6 D 1.8

B3Z: L 0.4 D 1.7

Blue - N

Grey - S

Silver - E

Gold - W

Platoon double play:

From Woolworth:

Leave 1700 - 0630

CP 1: L 0.4 D 1.2

2: L 0.4 D 1.0

3: L 0.4 D 0.7

Double play at CP 3 trail-stream junction

4: L 0.5 D 1.2

5: L 0.5 D 1.4 } off trail

~~27 MAR 69~~

26 MAR 69 - another Co. (-)

27 MAR 69 - 1st platoon - platoon patrol,  
NW.

'A' - contact almost every day.

'C' - some " on BFB & spottings.

In Op. JAOB - US, busy

Op. A'D almost covered - 'D' will  
take obj. 9 tomorrow - they're  
hunting.

27 MAR 69

Squad 2 blow bunkers 1300

No more than 2 men / hole;

50% alert during daylight.

If triggered - contact B-6

Keep comm. to minimum  
medium freq.

Pop-ups - take.

A

Classes need:

1. Co., Plt, movement.
2. Call 4 Fire - ~~and~~ actual adjust
3. Map reading
4. Spot repn, format, sketches
5. Small unit leadership

28 MAR 69

70. people wear helmets if quints have 2.

Plt: Double play - leave 1830 - hootch area at stream.

Analyze squads

Live like dogs - don't make it worse - police condition poor - 1<sup>st</sup> + MG's. Mind of getting chewed coz people break contact - get on people.

Fry order - 'B' continue present mission - sword slugs on Blue lines.

B3B 1900-0615  
From Sears: L0.3 D2.0

LP2 - B3P: From Sears;  
L0.5 D1.7

30 MAR 69

B3A 0800-1500

From Sears

1: L0.8 D1.7

2 L1.2 D1.8

3 L1.5 D1.7

4 L1.4 D2.1

5 L1.0 D2.1

6 L0.7 D2.1

7 L0.5 D2.2

8 L0.4 D1.9

B3C 1200-1630

From Seas

1	L 0.5	D 2.1
2	L 0.5	D 2.4
3	L 0.6	D 2.6
4	L 0.4	D 3.0
5	L 0.4	D 2.6
6	L 0.3	D 2.2
7	L 0.4	D 1.9

29 MAR 69

Radios, laws, ammo, frags - out  
of arm.

30 MAR 69

For 30 MAR 69: Nite 3

B3A send double

1915-0630

From WW

L 0.6 D 2.0

LP - B3p L 0.6 D 1.7

For 31 MAR 69:

B3B 0800-1530

From WW

1	L 0.7	D 1.5
2	0.9	1.3
3	1.1	1.2

4-4.5 D 1.3

5 L 1.7 D 1.4

6 L 1.5 D 1.7

7 L 1.2 D 1.8

8 L 1.8 D 1.8

B3C 0930-1600

From WW

1 L 0.8 D 2.1

2 L 1.0 D 2.4

3 L 1.3 D 2.5

4 L 1.5 D 2.7

5 L 1.2 D 3.0

6 L 0.8 D 2.9

7 L 0.5 D 2.6

8 L 0.4 D 2.2

30 MAR 69

3 APR 69 - lifted to <sup>745</sup> ~~745~~ (04-29)

Pravlt 745 heli-ammult. w. 'A'.

constructed LZ 4-2 batteries.

31 MAR 69

B3C Guard double.

1845 - 0630

From Saan: L 0.6 D 2.1

LP - Saan: L 0.7 D 1.7

B3P

1 APR 69

Move to (map) about 1 click

Police up.

Get ready to move.

Scheduled 2 move 1845

1, 3, CP, 4, 2

Make 25 rds.

Still prob. leave 3-5 days.

S-W

2 APR 69

Water runs - helmet, plate, rifle,

L.O. permits.

Patrols - if you're ahead of schedule,  
set on ambush.

Get Squad heads & track pits,

2 squad ambushes - separate areas.

[War From W - L 1.1]

B3A - west - streambed lv. 1830

~~B3A~~ - L 1.3 Up 0.2

trail, stream junct.

B3B - Southeast streambed lv. 1800

L 0.9 D 0.4

Use azimuths

3 APR 69

B3C Guard slinger to:

8821 grid - cover it.

One LP - Set line fillers

Need a map

Sq. L. - daily rep. - grenades -  
check pins. Cover in dense  
growth.

Eventually - Scout team / man; 3 water  
squad.

Sleep out of range of pile hole.

No hammocks. Sharpen E-tool.

Patrols - if arty wanted, go thru 'B'.

B3C

Sq. amb. - L 1.2 D 0.1 1900-1915

fix pit. - stream, trail junct. - 891 2/17

Bada to Passport 4 APR 69; leave early  
if can get external out. Can't leave  
until ext. gets out. Capt. sets  
pace.

What about amb?

" Oteny?

4 APR 69

B3A: 1900-0630 L 0.5 D 2.7

70 obj. 6 5 APR 69  
5 APR 69

Watch frags  
Fire plan sketch 2 X 0 6th

6 man LP's } 1/3 alert  
8620 - States

B3P L 0.9 up 1.7 1915-0630  
B3Z L 0.8 up 1.5 "

6 APR 69

B3A guard duty 0730-1530  
State

1: L 1.0 U 1.2  
2 L 1.1 U 0.7  
3 L 1.5 U 1.0  
4 L 1.8 U 1.1  
5 L 1.7 U 1.5  
6 L 1.4 U 1.7

7 L 0.9 U 1.9

B3C guard duty 0730-1600

1: L 0.9 U 1.9  
2 L 1.4 U 1.7  
3 L 1.7 U 1.8  
4 L 1.7 U 2.2  
5 L 1.7 U 2.7  
6 L 1.3 U 2.7  
7 L 1.0 U 2.5  
8 L 1.0 U 2.0  
9 L 0.8 U 1.8

Order washers?

~~Good w/ Hae / Frag check / Pistols~~  
6 APR 69

Nite 1915-0630  
P L 0.8 U 1.8  
Z L 0.7 U 1.4

Lv. tomorrow to 745 prob.  
Police - sq. pits.

7 APR 69

On 745 - 8-12 (12=N)  
Order from drop to obj - 1, CP, 3,  
Monty, 2,  
Op com - 2/3 several days.

On 745 - living areas far from  
fite holes. Will be 2 batta.  
there, many people. Will event  
be like Cates.  
1000 - all ready 2 go; leave prob.  
at 1130.

Sq. L's - watch jungle ext.  
XO + 2 HST people on last  
bird.  
3d plt - last out of here - security -  
3 bird falls +.  
7 APR 69

B3P from KC Athletics (0135)  
1915 R3.6 D5.1  
President's 9932  
Keep looktaker back from holes.  
8 APR 69

3<sup>rd</sup> sq. patrol tomorrow - sketch  
area report in detail 2 6.0, on  
map discrepancies, possible water  
pt.

LP R 3.6 D 5.0 - Pitt. Pirates  
B3P 1915-0630  
Fires? Yes  
Radios out by 1800 + when B'n here.

B3C Squad Sluggo from Ball time.  
1: R3.6 D5.3 0700-1500  
2 3.7 5.7  
3 3.8 6.0  
4 4.0 6.4  
5 4.2 6.2  
6 4.0 5.8  
7 3.8 5.5  
8 3.7 5.3

Plan tomorrow - clear, show clear  
by hand prints to Squads.  
LP - 3rd tomorrow  
Word to brook off work, eat will  
come from 5+6.

clean weapons when not work.  
How long here - plan when B'n arrives.  
Combat Sit. in area

Quiet  
Excellent job today - 6.  
Bride - flaks, boots, packbd. list  
to B'nny.

Corpsman - halizone,

B3A 10 APR 69  
0700 -  
From Means:

1:	R 3.2	D 4.6
2	3.0	4.4
3	2.9	4.2
4	2.8	3.9
5	2.7	3.6
6	2.8	3.2
7	3.0	3.0
8	3.3	2.8
9	3.1	3.2
10	3.1	3.6
11	3.2	4.2
12	3.2	4.7

With 81.

Thrust: Quantico	0832	✓
Bar	9831	✓
Dial	1023	✓
Bear	9925	✓
Hockey	0537	✓

11 APR 69

Here tonight, 1<sup>st</sup> Sq. back tomorrow.

NVA Reg's.

Ops pushed back a day - 31st

Police

Work parties - Lt/Cpl. W. - super.

✓ vision getting better,  
Machine recon team,

12 APR 69

Bunker detail.

✓ Sq. Lt's - have roster of your  
people - name, MOS, RTD, job,  
SN,

✓ Tell of Sapper circular.

W.H.

✓ 6 meals have 2 go in pan now or  
time as needed?

Rehab. dependent on little NVA activity.

NVA div. moving to earlier op. area.

5 days' chow

✓ If here some time, will improve  
points.

✓ Maybe move to final lines later  
tomorrow.

✓ Vitamins event. issued on daily  
basis.

✓ Pops - ops on order.

13 APR 69

Walt - mail card.

Empty H<sub>2</sub>O cans, Police, eat - next  
2 1/2 hrs.

Save 4 3d's,

Move tomorrow.

14 APR 69

Sq. Ls. - don't, SL in mind?

Year / C-rate /  
15 APR 69

Reg, Brn

Work 0730

Shade hoodies - anchor vs. choppers -  
stay packed.

Entire company back - build base  
today.

Wire, bags

Fire plan - minutes.

Perimeter patrol, ex. plst.

Prot. out of rehab. 18th, find out tomorrow

Comps (-) overwrite.

LP - 16 APR 69

042 305 - 250 m out

17 APR 69

Rehab - out 19th, maybe to  
VCB before Cua Viet. S/Sgt R.

Popice

Cleaned weapons - good.

B3P From MCB L 3.7 D1.5

Freq's:

Air 30.90 thru C.O.

Medevac 30.90

B'n. - 55.10

Co. - 30.45

Base - 54.32

C-4 to Gy.

Verify LRP's, 787 - ASAP

Clean rifles

Count - how many flak to be replaced?

Guide by 1700 daily:

A S. 56 rds.  
 B 45 "  
 C M-60 "  
 D Traps  
 E Smoke, colored  
 F " , screen  
 G Pops - up  
 H Hand illumina  
 I 60mm HE rds.  
 J " illum "  
 K " WP "  
 L MCI  
 M LRP  
 N Claymores  
 O LAAWS  
 P M-14 rds.  
 Q M-79 "  
 R Mags flares  
 S E-tools  
 T Plastic water bottles  
 U canteens  
 V Air panels  
 W Sterbe lites  
 X Compresses  
 Y C-4

Heliteams:

7<sup>th</sup> 10: 3 men from 1 sq. (AFT).  
 FO - C.O.  
 11: 1st Sq. (-) (8)  
 3 act. 1 C.O.  
 R.O. 1 (12)  
 Runner 1  
 Corp. 1  
 12: 2 Sq. 9 (12)  
 MG tm. 3  
 13: 3d Guide 1 C.O. (12)  
 3d Sq. 11  
 14: MG tm 4  
 Corp. 1  
 XO 1 C.O.

*Chad T. Johnson*

20 APR 69

No cook in bunker.

Police from anteroom.

" bunker you occupy.

Shower - 0800, 1700.

Air out beds.

Grab ass in aft.

Collect all out - center of plate.

clean rifles by 1800.

Lines at site - don't leave 2

wake relief.

Swine trucks, into on order.

3Z amb. [3A]

From Green:

L 1.7 D 0.3 (313 727)

in trees, 1930 - 0630

21 APR 69

Squad (R)

up to Ocean View on Otters,  
sweep to C-4, sq. wide.

0830 - 1400 From E-tool

1 - L 0.3 U 0.7

2 - L 0.3 D 0.2 E-Tool - 3074

3 - R 0.4 D 1.0 C-Bat - 2872

4 - R 0.5 D 1.7

5 - R 1.5 D 1.5

WA

C-4 - 304 723

21 APR 69

3P L 1.6 D 0.4 (on ord) 33 73  
Colors 73 73

313 726

22 APR 69

2. Slog. 1200 - 1800 Colors

1. L 1.7, D 0.1 - 313 729

2. L 2.5, D 0.5 - 305 725

3. L 3.0, D 0.0 - 300 730

4. L 3.0, U 0.6 - 300 736

5. L 2.1, U 0.6 - 304 736

6. L 1.3, D 0.2 - 317 728

Hem + 2872

Ragtail (animal) 3070

States 3569

Indians 3367

22 APR 69

3P: 2000 - 0630 Red

L 1.4 D 0.3

3Z: 1930 - 0630 "

L 2.2 D 0.5

23 APR 69

clones - mapping, claymore,  
1/2 cor. at time.

Haircuts, start.

List - sandals, etc from Cua Viet.

S/Sgt. Michael.

C-rats - pads up by time we leave here.

Blooper - 50 HE, 20 of rest. Have wjms, clean when we go to C.V.

Claymore shoot tomorrow <sup>many-class</sup> ~~apt~~

MG jamfire " apt?

Make care ea. man - Drunks.

No. holes, no trash when leave.

Swim call tomorrow apt.

B+ volley balls - to C.V. w. us.

Walk to C-V - boots, trunks, wjms, flats, gear rides.

MG + Radio SN's.

Note:

3P 2000-0630 Colon L 1.6 D ~~1.6~~ 0.4

3Z 2000-0630 " L ~~1.6~~ 0.7

24 APR 69

Notebooks avail? ✓

27 APR 69

<del>A-1/33</del>	<del>C-1/33</del>	A-1/33	C- 0/9
<del>B-1/2</del>	<del>D-1/44</del>	B- 0/2	D- 1/44

28 APR 69

A- C-

B- D-

Stage all gear outside tent by 0730+ stand-by 4 relief.

Do not leave anything in tent but rads.

Next 2,3 days - op con 9 man operate around Rockpile.

When 3 Mar new op - we sweep from Rockpile area south to Cam Lo area.

Clear wjms again tomorrow while await relief.

Guide - pass word 2 messmen to get all ready.

29 APR 69

Thrust pts.

Directs ~~95~~ 9459

Rambler 9555

Lidgeron 0060

Sports 0156

Guide names 9857

Local patrols - 2 hrs.  
Next.

1400 - be ready 2 move out by 53/2

1, CP, 2, 4, 3

1300 - strike tents.

0465:

Lifted to Sparrow, humming a click  
to end of Mutter's Ridge,

Thrust P.; 1 MAY 69

0164 - Citrus

0062 - Oil Cos.

0463 M.C. Generals

3d - left - 5 to 10

tie w. 1st on S. side

038 656 - 2

029 652 - 3

4 MAY 69

A. 1/24 C. 0/5

B. 0/2 D. 1/31 32

Water run of 2 MAY 69 - We gave  
✓ 3 lgs. + 2 sm. bottles - didn't  
get bottles or water.

~~Strike~~ slope of L 2, Reverse slope:

LP = 4 MAY 69

5 MAY 69

1 - 2 L Pa

2 - Sq. amb.

3 - 4 man LP - Singer

6 MAY 69

3d - pl't. patrol - 0630 out

Amb. on river:

CP 1 - 019 638

CP 2 - 020 635 - amb.

CP 3 - 023 638

7 MAY 69

A 1/2 1/6 C 0/6

B 0/2 D 1/3 1/4

Sq. Doubleplay - 50m downstream  
from present point. by 1800

2d pl't. relieves at 0800.

2d sq.

8 MAY 69

Start 9 MAY - were known as <sup>1/3 sq.</sup> BARCROFT.

3d MARDIN - Banister.

Hotel - Colonial Village.

3d Reg - Del Mar

2/3 - Guarding Star

3/3 - Wisdom Jacket

Records - map maker

Yacht 1, Bn. - 99.20 - M 698 prim.

" 2 - 43.35 - M 1148 prim.

" 2 - 65.80 - M 1250 sec.

81 conduct of fire - 59.15 - M 1079

'A' Co. - 74.20 - M 1139

'B' Co. - 72.95 - M 589

'C' Co. - 66.40 - M 990

D'Co - 64.90 - M483  
LZ control - 32.50 - M318  
Med. common - 45.70 - (no M-)

2, CP, 3, 4, 1

Dirty Women  
1 2 3 4 5 6 7 8 9 10

9 MAY 69

LP - 100m out 1930

Report when holes in.

A 1/25	C 0/5
B 0/2	D 1/32

Pct. patrol - ready by 0700.

10 MAY 69  
11 MAY 69

Chaplain services - 1600

Water watch.

No hootches

Now, water prob coming.

1700 - Check fingers w. sqm.

Clear patios - electric wire 50-75 m  
in front of lines.

trips, days.

Empty holes - 2 men/.

LP Sq.

A 1/30	C 0/5	H <sub>1</sub> 1/30
B 0/2	D 1/38	H <sub>2</sub> 0/8

12 MAY 69

Need 1 helmet

100% flasher

Need 17gren. powder

136 LRPa = 100%

25 E-tools

Need 22 grenades.

" 10 bandoleers

" 4 canteens (4:5/man)

13 MAY 69

All needs - into 7.

Pct. amb.

032 653

A-1/34	C-0/6
B-0/2	D-1/42

LP - 036 653

14 MAY 69

B3P M+2E - 0600

Vanilla; R1-S U, 1.3

A-1/32	C-0/5
B-0/2	D-1/39

B-0/2 D-1/39

15 MAY 69

Double, Sq.

16 MAY 69

Double, Sq.

A, C,  
B, D.

(32)

1630 - clear, patrol - from 21 to 3d.

Site est - 2 double, sites -

1: 200m outside lines on tango

2: 200m beyond #1

Stay until lat. lt. moves there  
in A.M.

Whist P.:

Countries 0862

Vanilla ~~0264~~ ~~0263~~ 0264

Magic 0666

Memor 0460

Johnson (Grand) 0959

Detroit 0555

Planets 0158

17 MAY 69

Site - R 1.8 D 3.8 Newsweek

Park - 0615

18 MAY 69 U+1 1/2 to recall:

1 R 2.0 D 4.0 U.S. News

2 R 2.9 D 3.9

3 R 3.2 D 3.6

4 R 2.5 D 3.4

5 R 1.8 D 3.3

6 R 1.4 D 3.5

18 MAY 69

A. 1/33 C. 0/5

B. 0/2 D. 1/40

LP - Dark, Dark site.

19 MAY 69

Malina tabs - plst, sgt, reports.

Wpn. clear, frags.

Mortar watch.

Op. 4 next week or so.

Whist P.: 20 MAY 69

Deer 9865

Scotch + water 1266

Dial 0061

Zenith 1163

Oak 0359

Kath. Hepburn 1371

L.A. Faber 0354

Vermont 0562

Hemingway 0758

James Doolittle 0865

Dennis Palmer 0568

Yellow 1357

LP

Holes, by, + plans

Mortar watch - 4 corners, all times.

All helmets + wear.

A 1/32 C 0/8  
B 0/2 D 1/39

21 MAY 69

H<sub>1</sub> 1/32 H<sub>1</sub> 2/32  
H<sub>2</sub> 0/7 H<sub>2</sub> 0/6

Mich Moore 1372  
Deer 1069  
Colo. 0668  
Rose 0766  
Drinks, also 0065  
Soap 9763  
Oaks 1264  
Steinbeck 0562  
Fiz Taylor 1061  
RCA 1359  
Stanford 0658  
Pan Am 0455  
Yellow 9961  
Chie Black Hawk 0360  
Jack Nicklaus 0634

22 MAY 69 Maps:  
U+1 to recall table (-)

1: L 0.6 U 0.3  
2: : 0.8 U 0.7  
3: L 0.9 U 1.1  
4: L 0.4 U 0.8

↑ Double, then recall.

~~Sq. Lt.:~~

↑ Practical - Here tomorrow -  
have plt. (-)

Series of obj's. ea. day or so,  
500m or so apart,  
tending to Com "Hien."

Bin. - Co. at Com "Hien", C-2,  
Cam Lo, + one drifts.

No veif. - rumor about rehab.

1st. plt. - 2 squads out - amb.

2d " - join us here now.

Remind - mortar watch, 2 up on

OP, LP

Sq. Lt. - give feedback when  
preparing to move, when  
ready. Entering area for  
rite - reports immediately -  
all people in, weapons clear,  
flags on.

Chow - another thing blamed on  
the "herd" - retaliate for a  
change instead of taking it.

"The change in command -

No officer ever forgets his  
first platoon, command,  
working unit, etc.

☐☐☐☐ - 22 MAY 69 - I'll leave, your  
platoon com. will be Lt. O'Neill.  
I become 4th platoon com. rest of  
tour.

Remember what Lt. Ryan said when  
he turned you over to me -

I expect the same again.

You'll find there's not as much  
of an adjustment to make  
as you might worry about.

Continue the improvement  
you're making - you're being  
noticed.

R + R:

S/Sgt. Goodlin's

4 rolls Kodak 124 (4 on instant), 2  
roll B+W, 2 color.

4th Plt: many notebooks.

Top: Rodriguez, recon.

O & R - Combat action?

Dog tags

Camera - Me + STRA, + film

Send home - Chi-Com, clips,  
maps, notebooks + pamphlets,  
letters, 1 roll film

St. O'Neill - Demo bag

15 APR Recommendations:

Recommended 15 APR 69: 70 Lt/Cpl.:

1. McIlwain 1 JUL 68 received
2. Rank 1 JUN 68 received
3. Pihe 1 SEPT 68 received
4. Toppin 1 AUG 68 rec. merit.
5. Duarte 1 DEC 68

Recommended 7 MAY 69: 70 Lt/Cpl.:

1. Pihe 1 SEPT 68 received
2. Toppin 1 AUG 68 received
3. Duarte 1 DEC 68
4. McGuigan 1 SEPT 68
5. McGuire 1 OCT 68

70 Cpl.:

1. DeLeon 1 NOV 68 received 15 MAY 69
2. Worthy 1 NOV 68 received "

70 Lt/Cpl.:

1. Toppin #4 1 AUG 68
2. Rank #2 1 JUN 68
3. Duarte 5 4 DEC 68
4. Pihe 3 1 SEPT 68
5. McIlwain #1 1 JUL 68
6. McGuigan 6 1 SEPT 68
7. McGuire 7 1 OCT 68
8. Hopkins 8 1 NOV 68
9. Guest 9 1 OCT 68
10. Houch 10 1 NOV 68
11. Krause 11 1 MAR 68

70 Cpl.:

1. ~~Worthy 1 NOV 68~~  
rec. merit.
2. Wimbush 1 NOV 68
3. ~~Wimbush~~
4. Myrisha 3 1 DEC 68
5. ~~DeLeon 1 NOV 68~~
6. Smith 5 1 DEC 68

~~70 Sgt.:~~

- ~~Williams (tie #th)~~  
~~McClosky~~

782 Bear lost

~~Toppin - helmet,~~

~~Grant - "~~

~~Krause - gas mask~~

~~Oster (C) - "~~

~~Dandridge (C) - helmet~~

3d Pkt. 782 gear

~~14 APR 64.~~

Cart. belts	44
Canteens	176
Helmets	44
E-tools	42
Ponchos	42
Belt sup.	12 m.
Painauits	23
Rubber ladies	30
Compasses	7
K-bars	5
Bayonets	4
Packs	44
Jungle bits	24
Gas masks	44
Poncho liners	4
Flak jackets	44
Menade ponchos	2
Radio packboards	2
M-79 vests	2
45 holsters	5

10 APR 69

7 pistols; 37 rifles; 3-79; 2-MG

27 APR 69

M-79a: 0362-1 ✓ Radios: 2393-1 ✓

107782-2- ~~3212~~ 3 ✓

10515-3 ✓ 17-9 (scratched out) ✓

Starlite: 12586 ✓ MG's: ~~5244~~ ~~65635~~

✓ 32944R/65635 ✓

~~██████~~

~~03/65-2~~

~~02/65-3~~

7 MAY 69

Radios:	M-79a:	MG's:	Starlite:
1-2393	1-0362	32944R	12586
3-5350	2-107782	65635	live Panache <sup>5</sup>
9M-17-9	3-10515		

Spot Report:

A - Unit [AP'B']

B - Date - Time Group

C - Coords. - from thrust pt.; Friend. + Enemy

D - Description

E - Action taken

F - Friendly KIA

G - " WIA - major & minor

H - " MIA

I - KIA - NVA & VC

K - POWs

L - Detainees

M - Weapons captured

N - Equipment + documents captured

Medevac:

~~Stacy~~

✓ Meath

~~Stacy~~

✓ Waddell

~~Frey~~

✓ Mars

15 MAR 69

~~Stacy~~

~~Hubert~~

✓ Swann

~~Stacy~~

✓ Stowe

~~Stacy~~

✓ Smith

~~Stacy~~

✓ Rank

~~Stacy~~

~~Stacy~~

~~Stacy~~

~~Stacy~~

~~Stacy~~

~~Stacy~~

~~Stacy~~

~~Stacy~~

~~Stacy~~

~~Stacy~~

1 MAY 69

~~Stacy~~

~~Stacy~~

✓ Ramey

~~Stacy~~

~~Stacy~~

✓ Hopkins

✓ Gibbons

~~Stacy~~

✓ Berndt

R+R:

~~Stewart~~

~~Wooten~~

~~Dandridge~~

~~Stewart~~

Hughes 1-7 MAY

McGuigan - 29 APR - 6 MAY

Mojin 24-29 APR.

~~Wooten (500) 8-15 MAY~~

DeLeon 18-23 MAY

Rear:

~~Dandridge~~

3rd Platoon  
Bravo Company

1st Battalion, 3d Marine, 3d MARDIV

CP: ~~██████████~~ 6

Lt. Anderson, C.R. A  
0105003/0302 16 MAR 43

895756 (45) 3 AUG 69 Prot.

S/Sgt. Goodlin, V.L. B-  
1635897/0369 2 AUG 36

992818 29 OCT 69 Prot.

Cpl. Mc Closkey, M.D. [Guide] A/  
2792643/0351 18 JAN 49

950372 23 JUL 69 Cath.

PFC Ward, C.L. (radio) O+  
2484800 16 JUL 48

712054 4 DEC 69 N.P.

HM1 Menner, W.C. O+  
B-18531/NEC/8404 16 MAY 45

1664011 (45) JUN 69  
13 DEC 69 Cath.

HN Norton, E.D. O+  
B614375/NEC/8495/8404 15 MAR 47

725773 13 JUL 69 Prot.

2181939 (45) ✓

Sgt. Satchi, D.D. [Guide]  
276473  
198764 17 JUN 69

L/Cpl. Smith, D.L. (radio) O  
2477927/0311 3 APR 49

612362 29 OCT 69  
13 NOV 69 Bapt.

HM3 Cattera, T.B. A+  
B814454 11 JAN 47

1518994 (45) 7 NOV 69 Cath.

PFC Pettitt, L. [runner] AB+  
2445383/0351 14 JUL 50

694588 3 MAR 70 Cath.

Sgt. Highley, C.E. [Guide] B  
1484232/0351 15 JAN 36

747337 5 JUN 69 Prot.

HM1 Hawley, R.D. O  
B511099 31 AUG 48

985268 (45) OCT 69 Prot.

90-1-10  
Cath.

11  
1st Squad  
Cpl/Balipai, J.D. [SL] 0  
211642/3 9 OCT 46  
778264 17 JUN 69 Cath.

Cpl. Worthy, K.T. [SL] A+  
2010951/0311 10 MAY 43  
552755 ✓ 30 OCT 69 P. 1

PFC Krane, D.E. O+  
2412442/0311 25 DEC 48  
~~771105~~ 25 SEPT 69 Cath.  
1829602 (45) ✓

PFC Duarte, J.D. B  
2450033/0311 5 OCT 48  
~~1829602 (45)~~ 15 JAN 70 Cath.  
244691 ✓  
~~0502~~

PFC O'Leary, H.S. A/  
2464281 24 NOV 48  
744691 24 FEB 70 Cath.

L/Cpl. Walt, G.R. [ETL 2 FEB 69] B+  
2232845/0311 25 DEC 48  
~~716700~~ 1 AUG 69 Cath.  
739287 ✓

Cpl. McLaughlin, M.D. [SL] 18 JAN  
2292643  
950372 23 JUL 69  
V. Rank, W.H. [ETL 3] A

2412701/0311 15 FEB 49  
~~702332~~  
~~750524~~ 9 AUG 69

PFC Hopkins, D.L. (radio) 0  
2464281/0311 29 JAN 49  
~~953281~~  
~~744891~~ ✓ 24 FEB 70 Cath.

PFC Weller, G.B. J  
2484027/0311 30 SEPT 49  
~~539882~~ 16 FEB 70 Cath.  
735952 ✓

PFC Sells, E.J. O/  
2436735 3 AUG 46  
728874 10 SEPT 69 Bayst.

PFC McGuire, V.A. A+  
2470938/0311 14 JUN 47  
743024 4 APR 70 Quaker

PFC Melichar, R.P. O+  
2474277/0311 3 SEPT 48  
641539 ✓ 14 APR 70 Cath.

PFC Wingo, D.R. 0-  
2485065/0311 2 JUN 50  
639630 14 APR 70 Cath.

Cpl. McElroy, M.D. [SL] A  
2292648/0351 18 JAN 49  
950372 23 JUL 69 Cath.

P.F.C. Meter, J.R. B+  
2521107/0311 22 AUG 49  
748206 7 JUN 70 Baptist.

P.F.C. Ortiz, A.C. O  
2498966/0311 8 DEC 50  
793788 8 JUN 70 Cath.

L/Cpl. Pirne, J.B. O  
2487439/0311 17 APR 50  
703677 29 FEB 70 Baptist.

2nd Squad

L/Cpl. Wimbush, H.L. [SL] A  
 2436675/0311 31 DEC 47  
 746819 ✓ 20 AUG 69 Bapt.

L/Cpl. Uppshaw, J.C. [ETL 1] A  
~~24552384277~~ 24 NOV 47  
 785013 30 MAY 69 Bapt.

PFC Rogers, R.A. A  
 2481002/0311 18 AUG 49  
 739585 ✓ 16 FEB 70 Bapt.

PFC Moore, V O+  
 2474938/0311 20 FEB 70 24 NOV 49  
~~548159 ✓~~  
~~742740~~ Bapt.

L/Cpl. ~~Wynn~~ Wynn, R.E. [ETL 1] JAN 69] O+  
 2444824/0311 24 FEB 50  
 992180 17 NOV 69 Meth.

PFC Wiegman, W.E. O+  
 2504816/0311 10 FEB 50  
 684894 ✓ 24 FEB 70 Meth.

PFC McClellan, D.C. A  
 2494237/0311 7 MAR 50  
~~2188915 (45)~~ 16 FEB 70 Meth.

PFC McGuigan, E.V. O+  
 2463164/0311 30 JAN 50  
 954763 29 OCT  
~~13 SEPT 69~~ Cath

PFC Spert, J.S. O  
 2455855/0351 6 JUL 49  
 951799 25 MAR 70

PFC Waddell, F A  
 2481689 27 APR 50  
 707768 4 APR 70 Meth.

PFC Peabody, G.D. O  
 953448 (10) 11 JUL 49  
 2464077 (SN) 0311 14 APR 70 Prot.

PFC Mara, C.M. O-  
 2446543/0311 19 DEC 49  
 621713 ✓ 14 APR 70 Bapt.

PFC Frey, D.A. [radio] O+  
 2497779/0311 15 MAR 50  
 711315 ✓ 26 MAR 70 L.D.S.

L/Cpl. Haspin, E.A. O  
 2420961/0311 19 AUG 48  
 791994 ✓ 12 JUL 69 Bapt.

PFC Patitti, L. AB+  
2445383/0351 14 JUL 50  
~~2062845~~  
~~894588~~ 13 MAR 70 Cath.

Cpl. Carter, G.D. [FTL 2 ~~APR~~<sup>MAY</sup> 69] A  
2383058/0311 8 JUL 49  
778395 ✓ 6 JUN 69 Bapt.

PFC Abner, E.L. B  
2527769/0311 11 OCT 50  
954133 22 MAY 70 Prot.

PFC Adams, J.W. A  
2515144/0311 16 JAN 50  
621841 22 MAY 70 Prot.

PFC. Stowe, P.A. O+  
2505157/0311 29 NOV 49  
694924 25 MAY 70 Meth.

3rd Squad

Cpl. Williams, T.E. [SL] 0  
 2422479/0311 JOINED: 1 SEPT 68 5 MAY 48  
 638754 ✓ 27 JUL 69 Prot.

S/Cpl. Myrnick, G. [FTL 1 OCT 68] 0  
 2407498/0311 JOIN: 19 AUG 68 20 JUL 48  
 733706 ✓ 18 SEPT 69 Bapt.

PFC Meeth, M.D. JOINED: 26 DEC 68 0  
 2496647/0311 9 JAN 48  
~~262939~~  
~~283499~~ ✓ 15 JAN 70 Cath.

PFC Houch, V.D. AB  
 2487439/0311 JOIN: 20 JAN 69 27 JUN 49  
 744870 ✓ 20 FEB 70 Meth.

PFC Gomez, R.N. 0-  
 2469301/0351 3 APR 49  
 768864 ✓ 28 FEB 70

S/Cpl. D'Aguiar, D. 0+  
 2400018 31 JUL 48  
 10015 (9) 12 DEC 69 Bapt.

S/Cpl. Mellama, J.E. [FTL 2 FEB 69] 0+  
 2435022/0311 JOIN: 29 AUG 68 24 AUG 50  
 951438 ✓ 27 SEPT 69 X-ian

PFC Pibe, J.R. 0  
 2487439/0311 JOIN: 29 JAN 69 15 APR 50  
 793677 ✓ 28 FEB 70 Bapt.

PFC Harper, V.P. A-  
 2496874/0311 JOIN: 9 MAR 69 1 SEPT 49  
 1112276 ✓ 9 APR 70 N.P.

PFC Petitti, L.A. AB+  
 2445383 14 JUL 50  
 694588 78 FEB 70 Cath.

PFC Waterfield, R.F. 0-  
 2480557/0311 JOIN: 18 MAR 69 3 SEPT 48  
 689499 ✓ 14 APR 70 Bapt.

PFC Hill, H. III A-  
 2494991/0311 JOIN: 17 MAR 69 11 SEPT 47  
~~995565~~  
 1725940 (45) ✓ 14 APR 70 Bapt.

S/Cpl. DeLeon, R. [FTL 3] B+  
 2193313/0311 JOIN: 12 AUG 68 17 MAY 47  
~~192477~~  
 725113 ✓ 9 SEPT 69 Cath.

P.F.C. Thatcher, V.D. 0  
 2478219/0311 25 APR 49  
 826412 29 MAY 70 Bapt.

P.F.C. *Midwell, B.W.*

2503557/0311

622784

29 MAY 70

A

1 OCT 50

Bayt,

1000  
1000  
1000  
1000  
1000

*Num*  
L/Cpl. Hughes, [SL]  
2445328/0331  
238372 9 AUG 69

A  
9 AUG 48  
Bapt.

PFC Ribbons, M.C. 2  
2463608/0331  
686661 ✓ 25 MAR 70

A  
2 OCT 50  
Meth.

PFC Symphing, M. [FL 1]  
2392582  
993780 15 JAN 70

A  
3 APR 49  
Bapt.

L/Cpl  
~~2417124/0331~~  
Dandridge, C.M.  
2417124/0331  
~~737755~~ ✓ 11 AUG 69

B  
6 MAR 49  
Bapt.

PFC Bijou, J.V.  
2488551  
2404959 (45) 4 FEB 70

B  
18 AUG 47  
Cath.

PFC Choy, G.K.  
2425679/0351  
150908 ✓ 28 SEPT 69

O  
2 JAN 49  
Prot.

PFC McLean, J.I.  
2395003  
990193 26 FEB 70

O  
14 MAR 50  
Meth.

PFC Billings, K.V.  
2460226/0331  
2008907 (45) ✓ 25 FEB 70

A  
16 FEB 50  
Bapt.

PFC Duhl, D.E. [IL 2]  
2449726  
770150 3 JAN 70

B  
2 APR 49  
Meth.

PFC Kennedy, R.E.  
2476506  
14 APR 70

A  
1 JAN 50  
Meth.

PFC BERNDT, I.L. 2  
2494694/0331  
2401946 (45) ✓ 5 FEB 70

B  
21 JAN 48  
Luth.

PFC Otery, H.S.  
2464281/0311  
<sup>639630</sup>  
~~715594~~ ✓ 24 FEB 70

A  
24 NOV 48  
Cath.

PFC Howard, L.V. 2  
2482018  
690620 4 FEB 70

B  
13 JUL 48  
C.D.S.

PFC Bennett, W.T.  
2470853/0341  
954192 ✓ MAY  
29 APR 70

O  
23 AUG 50  
Prot.

Lt. Col. Rodriguez, M.P.  
2427285 / ~~0331~~ 0331  
~~683539~~ ✓  
683539 8 JUN 69

P.F.C. Bennett, W.T.  
2470853 / 0341  
95492 29 APR 70

P.F.C. Swann, L, Jr.  
2495044 / 0351  
741524 4 MAY 70

A  
18 JUL 49  
Cath.

O  
23 AUG 50  
Prot.

O  
13 APR 49  
Prot.

"The mind dissolved into an elaborate study of nothingness. ~~Mount Moorhead~~  
The Blue Nile  
unsophisticated part was overwhelmed by  
~~the primitive present...~~ Blue Nile

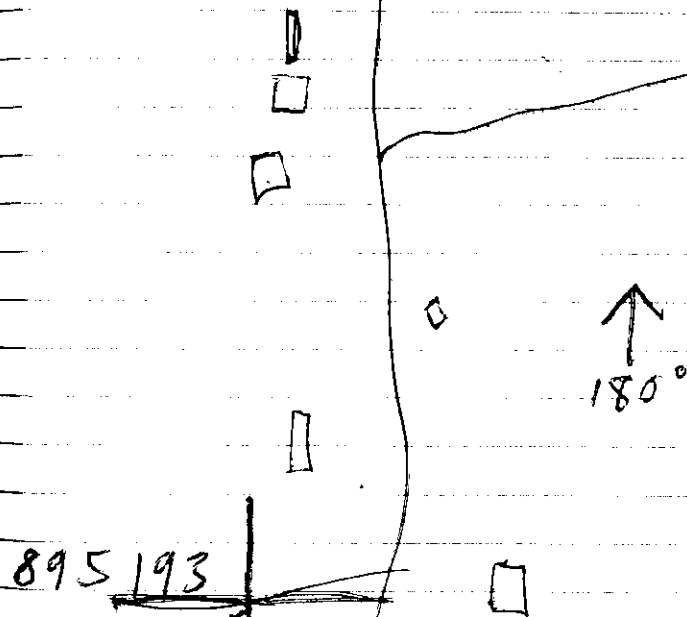

"Don't fire - there's a bunch of  
drunk marines out in front  
of the lines."  
"This new operation won't last  
more than two weeks."

$$\begin{array}{r} 165 \\ 112 \\ \hline 53 \end{array}$$

$$\begin{array}{r} 7 \\ 11 \\ 10 \\ 10 \\ 8 \\ \hline 46 \end{array} \quad \begin{array}{r} 7 \\ 10 \\ 10 \\ 7 \\ \hline 44 \end{array}$$

$$\begin{array}{r} 10 \\ 9 \\ 11 \\ 7 \\ 7 \\ \hline 44 \end{array}$$

$$\begin{array}{r} 26 \\ 30 \\ 34 \\ \hline 90 \end{array}$$

$$\begin{array}{r} 6 \\ 10 \\ 11 \\ 10 \\ 6 \\ \hline 43 \end{array}$$

$$\begin{array}{r} 6 \\ 10 \\ 9 \\ 11 \\ 8 \\ \hline 44 \end{array}$$

$$\begin{array}{r} 7 \\ 10 \\ 10 \\ 11 \\ 7 \\ \hline 45 \end{array}$$

$$\begin{array}{r} 3 \\ 31 \\ 30 \\ 34 \\ \hline 98 \end{array}$$

$$\begin{array}{r} 28 \\ 30 \\ 125 \\ 83 \\ 9 \\ \hline 225 \end{array}$$

$$\begin{array}{r} 6 \\ 10 \\ 10 \\ 11 \\ 8 \\ \hline 45 \end{array}$$

$$\begin{array}{r} 7 \\ 11 \\ 9 \\ 11 \\ 6 \\ \hline 44 \end{array}$$

$$\begin{array}{r} 11 \\ 16 \\ \hline 27 \end{array}$$

32

$$\begin{array}{r} 1/31 \\ 7 \\ \hline 1/24 \end{array}$$

$$\begin{array}{r} 6 \\ 10 \\ 10 \\ 9 \\ 5 \\ \hline 40 \end{array}$$

6

$$\begin{array}{r} 24 \\ 30 \\ 34 \\ 88 \\ \hline 79 \end{array}$$

$$\begin{array}{r} 62 \\ 27 \\ \hline 75 \end{array}$$

$$\begin{array}{r} 6 \\ 6 \\ 6 \\ 9 \\ 5 \\ \hline 32 \end{array}$$

$$\begin{array}{r} 5 \\ 10 \\ 10 \\ 11 \\ 8 \\ \hline 45 \end{array}$$

$$\begin{array}{r} 7 \\ 9 \\ 9 \\ 31 \\ \hline 42 \end{array}$$

$$\begin{array}{r} 44 \\ 6 \\ 38 \\ 8 \\ \hline 34 \end{array}$$

$$\begin{array}{r} 6 \\ 6 \\ 10 \\ 6 \\ \hline 36 \end{array}$$