

APPENDIX D

REGULATIONS FOR SPECIFIC GUARD POSTS

GENERAL ORDERS FOR THE GUARD

1. General Instructions: Guard duty aboard the ship is an important job. All orders are issued for a definite reason, and MUST BE ENFORCED. Ship's rules and regulations unless otherwise stated, apply to officers, enlisted men, and all other persons in a passenger status. Guards are directed to perform all of their duties efficiently. All guards will stand guard ON THEIR FEET. Sitting down or reading while performing guard duty will be cause for disciplinary action. The uniform for all guard duty will be fatigues, low quarter shoes, brassards, and helmet liner, except for those guards on exposed stations in inclement weather. Any exceptions to the above will be as prescribed by the Senior Unit Commander with concurrence of the Commanding Officer, Military Department. The following special orders will be rigidly enforced:

- a. Decks will be kept clean at all times. Permit no one to throw refuse or cigarettes on the decks or over the side. GI cans should be utilized.
- b. Permit no destruction or misuse of government property.
- c. Permit no one to sit on railings, or to climb upon gear, rigging, life saving equipment, or deck machinery.
- d. Guards will assist in regulating traffic and maintaining order during fire and boat drills. Enforce NO SMOKING regulations during all emergency drills.
- e. Allow NO ONE to smoke on the open decks while the ship is alongside the pier.
- f. Allow no gambling of any form.
- g. Permit no one to bring bedding, mattresses, pillows or blankets to the open decks.
- h. Curfew for the troops is at 2300 hours. Clear all decks, lounges and assembly areas by 2230 hours.
- i. Enforce the uniform regulations prescribed by the Senior Unit Commander.
- j. Guards will not interfere with the ship's crew or members of the Military Department while on duty.
- k. All guards are to remain at their posts during drills, to direct traffic and insure people are in appropriate dress. The only exception is the ABC Drill at which time guards on open decks will go inside through the door nearest them.
- l. Report all questionable acts by members of the ship's crew to the OOD.
- m. When relieved, turn over helmet, brassard and orders to your relief.

n. To report a fire or other emergency, communicate with the bridge by the shortest possible route.

o. Take the following action when a man goes overboard:

(1) Yell "Man Overboard", then throw orange lifering (found along rail) over the side.

(2) Communicate with the bridge by phoning 222, or use PA system, or run directly to the bridge. Report to watch the location of man and time overboard.

p. The signal for fire is a continuous rapid ringing of ship's bell for a period of not less than ten (10) seconds, supplemented by a continuous ringing of the general alarm bells for not less than (10) seconds. The signal for abandon ship is seven (7) or more short blasts and one (1) long blast on the ship's whistle supplemented by the same signal on the general alarm bell. Keep troops moving smartly. Do not let them run. For fire, direct all troops to return to their compartments; for abandon ship direct them all topside. The signal for "Secure from Drill" is three (3) short blasts.

2. Guard life jackets are in orange bags located at each post. To be used only in actual emergency.

3. Guards are to remain on post during all drills unless otherwise directed. (refer to paragraph K)

4. Guards will eat prior to relieving Guard Detail.

GUARD POST LOCATIONS

Guard Post

Location 02 Deck (Two Decks above Main Deck)

GP #1*
GP #2*

02 Deck, PATROL Starboard Side
02 Deck, PATROL Portside

Guard Post

Location 01 Deck (One Deck above Main Deck)

GP #3*
GP #4*
GP #5*
GP #6*
GP #7*

01 Deck, PATROL Starboard Side Hospital
01 Deck, PATROL Portside Hospital
01 Deck, Rear of Hospital
01 Deck, PATROL forward of Deck House
01 Deck, Inside entrance to Hospital

Guard Post

Location Main Deck

GP #8*
GP #9*
GP #10*
GP #11*
GP #12*
GP #13*
GP #14*
GP #15*

Main Deck forward, Portside
Main Deck forward, Starboard Side
Main Deck, Cabin PX in Cabin Lounge
Main Deck, (Promenade Deck), Starboard Side
Main Deck, (Promenade Deck), Portside
Main Deck, (Rear of Promenade Deck), Starboard Side
Main Deck, (Rear of Promenade Deck), Portside
Main Deck, Fantail, Rear end of Ship

Guard Post

Location 2nd Deck (One Deck below Main Deck) Troop Mess Hall Level

GP #16
GP #17
GP #18
GP #19
GP #20
GP #21

2nd Deck, Ladderwell #1
2nd Deck, Ladderwell #2
2nd Deck, Ladderwell #2A
2nd Deck, Ladderwell #3
2nd Deck, Ladderwell #3A
2nd Deck, Ladder leading to Promenade Deck Starboard Side. To be used as EXIT only during meal times. EMERGENCY anytime.

GP #22

2nd Deck, Ladder leading to Promenade Deck Portside. To be used as EXIT only during meal times. EMERGENCY anytime.

GP #23

2nd Deck, Starboard Side, Mess Hall, door used as EXIT from Mess Hall.

GP #24

2nd Deck, Portside, Mess Hall, door leading to Crew Quarters.

GP #25
GP #26
GP #27
GP #28
GP #29

2nd Deck, Ladderwell #5
2nd Deck, Ladderwell #6
2nd Deck, Ladderwell #6A
2nd Deck, Ladderwell #7
2nd Deck, Ladderwell #7A

Guard Post

Location 3rd Deck (Two Decks below Main Deck)

GP #30
GP #31
GP #32
GP #33

3rd Deck, PATROL passageway, forward of Troop Galley
3rd Deck, Starboard Side, across from Chaplain's Office
3rd Deck, Portside, Troop PX
3rd Deck, Ladderwell #5

Guard Post

Location 4th Deck (Three Decks below Main Deck)

GP #34
GP #35

4th Deck, Portside, Small Troop Recreation Room
4th Deck, Starboard Side, Large Troop Recreation Room

* GP are weather deck posts. Guards are not to step in ladderwells or in deck houses for shelter.

Ladderwell guards are to remain INSIDE ladderwells.

SPECIAL ORDERS FOR GUARDS AND GUARD LOCATIONS

POST #1 Ø2 Deck, Starboard Side

1. Patrol area and enforce the general regulations.
2. Enforce the "OFF LIMITS" restrictions for all troops.
3. Act as a lookout for men overboard.

POST #2 Ø2 Deck, Portside

1. Patrol area and enforce the general regulations.
2. Enforce the "OFF LIMITS" restrictions for all troops.
3. Act as a lookout for men overboard.

POST #3 Ø1 Deck, Starboard Side

1. Patrol starboard side of this deck and enforce general regulations.
2. Prevent unauthorized personnel from entering the hospital area.
3. Act as a man overboard lookout.
4. OFF LIMITS TO ALL TROOPS.

POST #4 Ø1 Deck Portside

1. Patrol portside of the deck and enforce general regulations.
2. Prevent unauthorized personnel from entering hospital area.
3. This is a walk-thru passageway only; no loitering at any-time.
4. Act as a man overboard lookout.

POST #5 Ø1 Deck, rear of hospital

1. Carry out the general regulations and orders.
2. Act as a traffic watch for troops. Permit no troop to enter Starboard Side of the Ø1 deck. Direct all traffic to the Portside.
3. Permit no loitering in the hospital area.
4. Keep silence about the deck.

POST #6 Ø1 Deck (forward of deck house)

1. Patrol the area and enforce the general regulations.
2. Keep all troops off deck machinery, lifeboats and rigging.
3. Prevent the use of lights except by ships crew forward of the bridge between sunset and sunrise.

POST #7 Hospital area, outside doctor's office

1. Prevent troops and passengers from entering hospital area except during sick call hours or in the event of an emergency.
2. Maintain silence in the area at all times.
3. Enforce NO SMOKING regulations in this area at all times.
4. Carry out special orders of the Medical Officer.

POST #8 Main Deck, portside, from deck house patrol area to Forecastle

1. Enforce the general regulations.
2. Permit no troops to enter the carpenter shop or Boatwain spaces.
3. Permit no troops to climb the ladder to the forecastle.
4. Prevent personnel from sitting on the railing, deck machinery, rigging, ladders, etc.
5. Prevent the use of lights except by crew members forward of the bridge between sunset and sunrise.
6. Keep troops from entering officers country through water tight door 1-61-2.
7. Act as a man overboard lookout.

POST #9 Main deck, starboard side, from deck house to forecastle

1. Patrol area and enforce the general regulations.
2. Permit no troops to enter the carpenter shop or Boatswain spaces.
3. Permit no troops to climb the ladder to the forecastle.
4. Prevent personnel from sitting on railing, deck machinery, rigging, ladders, etc.
5. Prevent the use of lights except by crew members between sunset and sunrise.
6. Keep all troops from entering officers country.
7. Act as a man overboard lookout.

POST #10 Cabin Class Ship's Exchange and Purser's Office

1. Act as a security watch for the cabin class store and purser's office.
2. Permit no passengers to enter the store.

POST #11 Main deck, starboard side frame 93-160

1. Patrol area and enforce the general regulations.
2. Prevent troop class passengers from entering the area forward of frame 160.
3. Act as a man overboard lookout.
4. Prevent troops on KP detail from loitering in the area.

POST #12 Main deck port side frame 93-160

1. Patrol area and enforce the general regulations.
2. Prevent troop class passengers from entering the area forward of frame 160.
3. Act as a man overboard lookout.
4. Prevent troops on KP detail from loitering in the area.

POST #13 Main deck starboard side frame 160-295

1. Patrol area and enforce general regulations.
2. Prevent troops from entering cabin areas.
3. Keep personnel off of deck machinery.
4. Act as a man overboard lookout.
5. Prevent troops from littering the decks. GI cans are to be used.

POST #14 Main deck, portside, frame 160-295

1. Patrol area and enforce general regulations.
2. Prevent troops from entering cabin areas.
3. Keep personnel out of deck machinery.
4. Act as a man overboard lookout.
5. Prevent troops from littering the decks. GI cans are to be used.

POST #15 Fantail

1. Patrol area and enforce general regulations.
2. Prevent troops from entering cabin areas.
3. Keep personnel off of deck machinery.
4. Act as a man overboard lookout.
5. Prevent troops from littering the decks. GI cans are to be used.

POST #16 Ladderwell #1

1. Permit no loitering in this area.
2. Insure that ladderwell is cleared of debris and will provide a safe exit in time of EMERGENCY.
3. Assist in expediting traffic during all EMERGENCY drills.

POST #17 Ladderwell #2

1. Permit no loitering in this area
2. Insure that ladderwell is cleared of debris and will provide a safe exit in time of EMERGENCY.
3. Assist in expediting traffic during all EMERGENCY drills.

POST #18 Ladderwell #2A

1. Permit no loitering in this area.
2. Insure that ladderwell is cleared of debris and will provide a safe exit in time of emergency.
3. Assist in expediting traffic during all EMERGENCY drills.
4. Prevent destruction of government property.
5. Allow no one to tamper with Coke machine.

POST #19 Ladderwell #3, 01 deck and 2nd deck

1. Permit no loitering in this area during inspections.
2. Insure that ladderwell is cleared of debris and will provide a safe exit in time of necessary.
3. Permit no troop class passengers to enter Officers country on the main deck.
4. Assist in expediting traffic during all EMERGENCY drills.

POST #20 Ladderwell 3A, 01 deck to 2nd deck to 1st Platform

1. Permit no loitering in this area during inspections.
2. Insure that ladderwell is cleared of debris and will provide a safe exit in time of emergency.
3. Permit no troops to enter officers country on the main deck.
4. Assist in expediting traffic during all EMERGENCY drills.
5. Maintain order of line awaiting entry into barber shop.

POST #21 2nd Deck, starboard side, frame 100 doorway (from mess hall to Officers Lounge)

1. Patrol area and enforce general regulations.
2. Prevent troop class passengers from using the ladder to cabin lounge.
3. Enforce safety and sanitary regulations in troop mess.
4. Permit no one to take food from the mess.

POST #22 2nd Deck, Ladder leading to Promenade Deck Portside

1. Patrol area and enforce general regulations.
2. Prevent troop class passengers from entering the crews quarters.
3. Enforce safety and sanitary regulations in the troop mess.
4. To be used for EXIT ONLY during meal hours.

POST #23 2nd Deck, starboard side, frame 130 (exit from Mess Hall)

1. Patrol areas and enforce general regulations.
2. Permit no troops to use ladderwell #4A to go above the 2nd deck except in general EMERGENCY.
3. Enforce safety and sanitation regulations in the troop mess.
4. Permit no one to take food from the mess.
5. Permit no troop class passengers to enter Officer's Country.
6. To be used for EXIT ONLY during meal hours.

POST #24 2nd Deck, portside, frame 130 (doorway to crews quarters)

1. Patrol area and enforce general regulations.
2. Prevent troop class passengers from entering the crews quarters.
3. Enforce safety and sanitary regulations in the troop mess.
4. Permit no one to take food from the mess.

POST #25 Ladderwell #5, main deck to 2nd deck

1. Permit no loitering in this area during inspections.
2. Insure that ladderwell is cleared of debris and will provide a safe exit in time of EMERGENCY.
3. Assist traffic control in routing traffic.
4. Assist in expediting traffic during all EMERGENCY Drills.

POST #26 Ladderwell #6, Main deck to 2nd deck

1. Permit no loitering in this area during inspections.
2. Insure that ladderwell is cleared of debris and will provide a safe exit in time of EMERGENCY.
3. Assist in expediting traffic during all EMERGENCY Drills.

POST #27 Ladderwell #6A

1. Permit no loitering in this Area during inspections.
2. Insure that ladderwell is cleared of debris and will provide a safe exit in time of emergency.
3. Assist in expediting traffic during all EMERGENCY Drills.
4. Allow NO ONE to tamper with the "Coke" machine.

POST #28 Ladderwell #7

1. Permit no loitering in this area during inspections.
2. Insure that ladderwell is cleared of debris and will provide a safe exit in time of EMERGENCY.
3. Assist in expediting traffic during all EMERGENCY Drills.

POST #29 Ladderwell #7A

1. Permit no loitering in this area during inspections.
2. Insure that ladderwell is cleared of debris and will provide a safe exit in time of EMERGENCY.
3. Assist in expediting traffic during all EMERGENCY Drills.

POST #30 3rd Deck, passageway forward of troop galley

1. Patrol area and enforce general regulations.
2. Keep troop class passengers forward of the galley area.
3. Permit no loitering on ladderwell #4.
4. Prevent unauthorized persons from using the elevator.

POST #31 3rd Deck, starboard side of Troop Exchange

1. Patrol area and enforce general regulations.
2. Permit no troops to move forward or aft into crew quarters.
3. Maintain general safety precautions in the store area.
4. Assist traffic control in regulating traffic.

POST #32 3rd Deck, portside, Troop Exchange

1. Act as a security watch for the Troop Exchange.
2. Permit no troops to loiter in this area.
3. Allow no troops to line up until 5 minutes prior to opening of store
4. Permit no troops to move forward or aft into crew quarters.

POST #33 Ladderwell #5, 2nd deck to 1st Platform

1. Permit no loitering in this area during inspections.
2. Insure that ladderwell is cleared of debris and will provide a safe exit in time of EMERGENCY.
3. Assist traffic control in routing traffic.
4. Allow NO ONE to tamper with the "Coke" Machine.

POST #34 Small Troop Recreation Room, 4-146-2-L

1. Maintain proper order in this area.
2. Prior to daily inspection at 1000 hours keep all troops out of this area except on cleaning areas.
3. Allow NO ONE to remove or damage any government property.
4. Clear area at 2230 hours.
5. Keep troops from congesting library area.
6. Prevent gambling in area.
7. Allow NO ONE to tamper with "Coke" Machine.

POST #35 Large Troop Recreation Room 4-146-1-L

1. During divine services clear area of all troops except those in attendance.
2. Clear area at 2230.
3. This area OFF LIMITS to 1300 daily.
4. Allow NO SMOKING during movies.

APPENDIX E

USNS GENERAL JOHN POPE (T-AP 110)

TROOP STANDARD PLAN OF THE DAY *

- 0030: Relieve the watch (Guards, CQ's, Orderlies, etc.)
- 0330: Relieve the watch (Guards, CQ's, Orderlies, etc.)
- 0445: Reveille for KP's. Muster all KP's.
- 0530: Reveille for all troops. Muster all troops. Compartment Commanders turn in troop muster reports to Troop Office. Breakfast for KP's and Guards.
- 0600: Breakfast for troops.
- 0615: Relieve the watch (Guards, CQ's, Orderlies, etc.)
- 0730: Screening by Troop Corpsmen for sick call in small recreation room.
- 0800: Turn to. Make all preparations for morning inspection.
- 0800-1000: Sick Call in Troop Examining Room.
- 0900: Voyage Staff Conference in Troop Office. Troop Exchange Store open. Game issue room open.
- 0930: Catholic Rosary in Ship's Chapel.
- 1000: Inspection of all troop spaces.
- 1000: Troop Barber Shop opens.
- 1015: Protestant Church Service in Ship's Chapel.
- 1100: Lunch for KP's, Guards, CQ's, Orderlies, etc. Sweep down all decks. Dump all trash.
- 1125: Secure from ship's work.
- 1130: Lunch for troops. Relieve the watch (Guard, CQ, Orderlies, etc.)
- 1300: Turn to. Sweep down all decks. Continue ship's work. Exchange Store open. Library open. First movie in Troop recreation Room.
- 1500: Second movie in Troop Recreation Room. Sweep down all decks. Dump all trash.
- 1530: Dinner for KP's, Guards, CQ's, Orderlies, etc.)
- 1555: Secure from ship's work.
- 1600: Dinner for troops.
- 1615: Relieve the watch (Guards, CQ's, Orderlies, etc.)
- 1700: Third movie in Troop Recreation Room. Sweep down all decks. Dump all trash.
- 1900: Fourth movie in Troop Recreation Room. Special Services Events - tournaments, Bingo, and/or entertainment in Troop Mess Hall. Library open. Sweep down all decks. Dump all trash.
- 2030: Relieve the watch (Guards, CQ's, Orderlies, etc.)
- 2100: Sweep down all decks. Dump all trash.
- 2200: Safety Inspection of all troop spaces.
- 2230: Troops return to assigned berthing areas.
- 2300: Taps. Lights out. All hands turn in. Keep silence throughout the ship. The smoking lamp is out in all spaces.

* May be adjusted as required by the Senior Unit Commander.

Cabin Class

F - 1

01 DECK

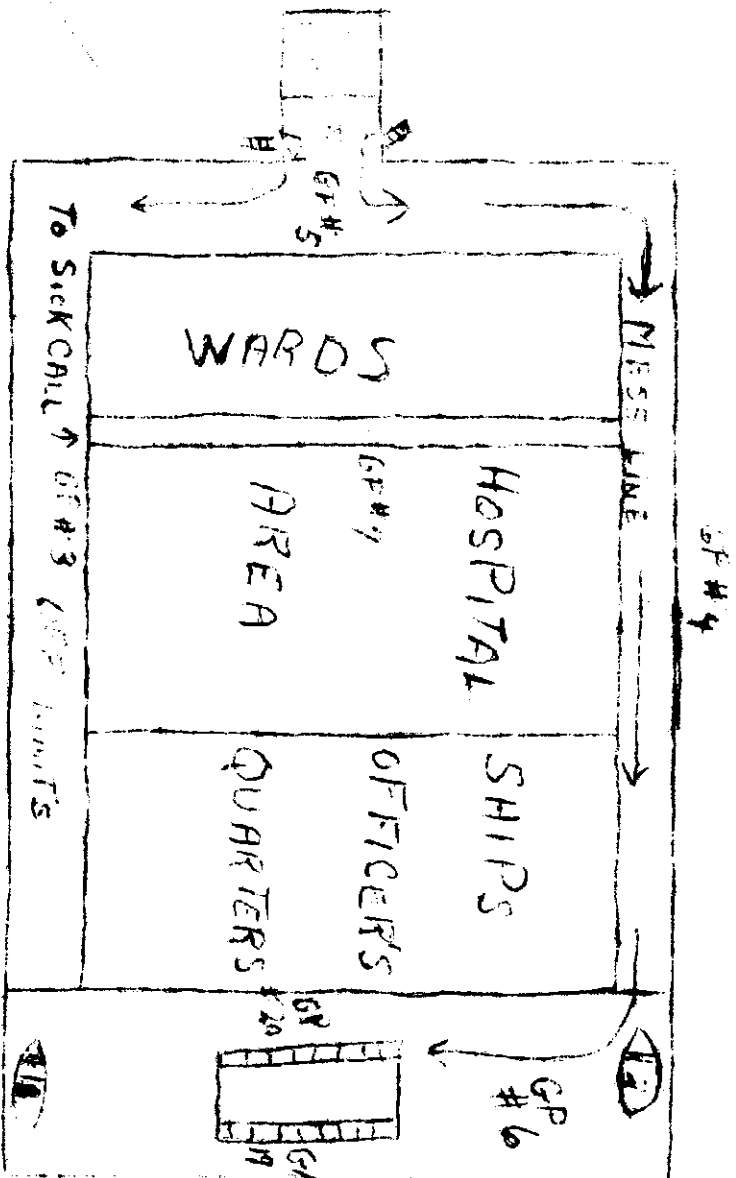

OFF
LIMITS

ROCKING
PUMPING
BAG

OFF LIMITS

OFF FORECASTLE
LIMITS

G-1

MAIN DECK

BARBER
SHOP

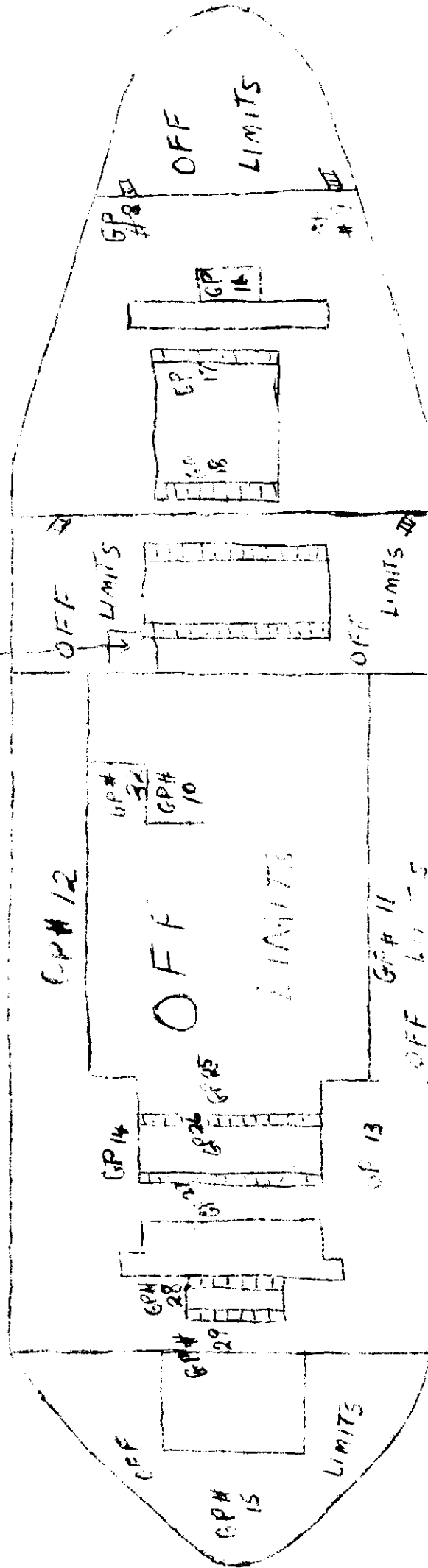

3RD DECK

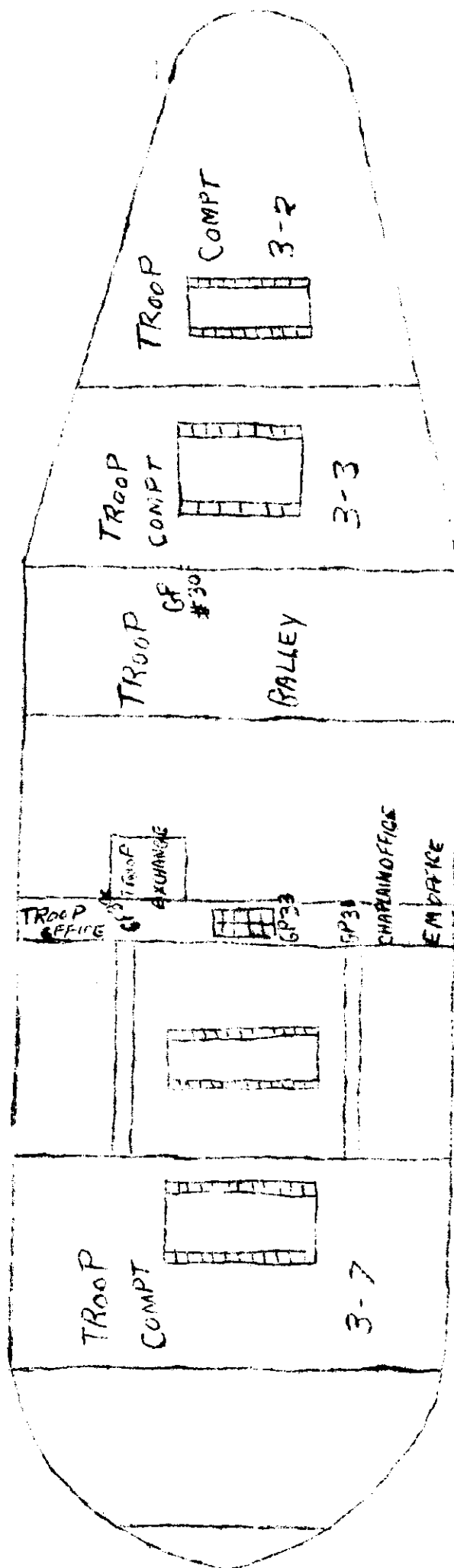

[illegible]

PARADE
CARBON OFF
LIMIT

DRIVER
SHOTS

WON BATT
OFFICERS
MESS

7A

1	2	3	4	5	6	7	8	9	10	11	12	13	14	15	16	17	18	19	20	21	22	23	24	25	26	27	28	29	30	31	32	33	34	35	36	37	38	39	40	41	42	43	44	45	46	47	48	49	50	51	52	53	54	55	56	57	58	59	60	61	62	63	64	65	66	67	68	69	70	71	72	73	74	75	76	77	78	79	80	81	82	83	84	85	86	87	88	89	90	91	92	93	94	95	96	97	98	99	100	101	102	103	104	105	106	107	108	109	110	111	112	113	114	115	116	117	118	119	120	121	122	123	124	125	126	127	128	129	130	131	132	133	134	135	136	137	138	139	140	141	142	143	144	145	146	147	148	149	150	151	152	153	154	155	156	157	158	159	160	161	162	163	164	165	166	167	168	169	170	171	172	173	174	175	176	177	178	179	180	181	182	183	184	185	186	187	188	189	190	191	192	193	194	195	196	197	198	199	200	201	202	203	204	205	206	207	208	209	210	211	212	213	214	215	216	217	218	219	220	221	222	223	224	225	226	227	228	229	230	231	232	233	234	235	236	237	238	239	240	241	242	243	244	245	246	247	248	249	250	251	252	253	254	255	256	257	258	259	260	261	262	263	264	265	266	267	268	269	270	271	272	273	274	275	276	277	278	279	280	281	282	283	284	285	286	287	288	289	290	291	292	293	294	295	296	297	298	299	300	301	302	303	304	305	306	307	308	309	310	311	312	313	314	315	316	317	318	319	320	321	322	323	324	325	326	327	328	329	330	331	332	333	334	335	336	337	338	339	340	341	342	343	344	345	346	347	348	349	350	351	352	353	354	355	356	357	358	359	360	361	362	363	364	365	366	367	368	369	370	371	372	373	374	375	376	377	378	379	380	381	382	383	384	385	386	387	388	389	390	391	392	393	394	395	396	397	398	399	400	401	402	403	404	405	406	407	408	409	410	411	412	413	414	415	416	417	418	419	420	421	422	423	424	425	426	427	428	429	430	431	432	433	434	435	436	437	438	439	440	441	442	443	444	445	446	447	448	449	450	451	452	453	454	455	456	457	458	459	460	461	462	463	464	465	466	467	468	469	470	471	472	473	474	475	476	477	478	479	480	481	482	483	484	485	486	487	488	489	490	491	492	493	494	495	496	497	498	499	500	501	502	503	504	505	506	507	508	509	510	511	512	513	514	515	516	517	518	519	520	521	522	523	524	525	526	527	528	529	530	531	532	533	534	535	536	537	538	539	540	541	542	543	544	545	546	547	548	549	550	551	552	553	554	555	556	557	558	559	560	561	562	563	564	565	566	567	568	569	570	571	572	573	574	575	576	577	578	579	580	581	582	583	584	585	586	587	588	589	590	591	592	593	594	595	596	597	598	599	600	601	602	603	604	605	606	607	608	609	610	611	612	613	614	615	616	617	618	619	620	621	622	623	624	625	626	627	628	629	630	631	632	633	634	635	636	637	638	639	640	641	642	643	644	645	646	647	648	649	650	651	652	653	654	655	656	657	658	659	660	661	662	663	664	665	666	667	668	669	670	671	672	673	674	675	676	677	678	679	680	681	682	683	684	685	686	687	688	689	690	691	692	693	694	695	696	697	698	699	700	701	702	703	704	705	706	707	708	709	710	711	712	713	714	715	716	717	718	719	720	721	722	723	724	725	726	727	728	729	730	731	732	733	734	735	736	737	738	739	740	741	742	743	744	745	746	747	748	749	750	751	752	753	754	755	756	757	758	759	760	761	762	763	764	765	766	767	768	769	770	771	772	773	774	775	776	777	778	779	780	781	782	783	784	785	786	787	788	789	790	791	792	793	794	795	796	797	798	799	800	801	802	803	804	805	806	807	808	809	810	811	812	813	814	815	816	817	818	819	820	821	822	823	824	825	826	827	828	829	830	831	832	833	834	835	836	837	838	839	840	841	842	843	844	845	846	847	848	849	850	851	852	853	854	855	856	857	858	859	860	861	862	863	864	865	866	867	868	869	870	871	872	873	874	875	876	877	878	879	880	881	882	883	884	885	886	887	888	889	890	891	892	893	894	895	896	897	898	899	900	901	902	903	904	905	906	907	908	909	910	911	912	913	914	915	916	917	918	919	920	921	922	923	924	925	926	927	928	929	930	931	932	933	934	935	936	937	938	939	940	941	942	943	944	945	946	947	948	949	950	951	952	953	954	955	956	957	958	959	960	961	962	963	964	965	966	967	968	969	970	971	972	973	974	975	976	977	978	979	980	981	982	983	984	985	986	987	988	989	990	991	992	993	994	995	996	997	998	999	1000	1001	1002	1003	1004	1005	1006	1007	1008	1009	1010	1011	1012	1013	1014	1015	1016	1017	1018	1019	1020	1021	1022	1023	1024	1025	1026	1027	1028	1029	1030	1031	1032	1033	1034	1035	1036	1037	1038	1039	1040	1041	1042	1043	1044	1045	1046	1047	1048	1049	1050	1051	1052	1053	1054	1055	1056	1057	1058	1059	1060	1061	1062	1063	1064	1065	1066	1067	1068	1069	1070	1071	1072	1073	1074	1075	1076	1077	1078	1079	1080	1081	1082	1083	1084	1085	1086	1087	1088	1089	1090	1091	1092	1093	1094	1095	1096	1097	1098	1099	1100	1101	1102	1103	1104	1105	1106	1107	1108	1109	1110	1111	1112	1113	1114	1115	1116	1117	1118	1119	1120	1121	1122	1123	1124	1125	1126	1127	1128	1129	1130	1131	1132	1133	1134	1135	1136	1137	1138	1139	1140	1141	1142	1143	1144	1145	1146	1147	1148	1149	1150	1151	1152	1153	1154	1155	1156	1157	1158	1159	1160	1161	1162	1163	1164	1165	1166	1167	1168	1169	1170	1171	1172	1173	1174	1175	1176	1177	1178	1179	1180	1181	1182	1183	1184	1185	1186	1187	1188	1189	1190	1191	1192	1193	1194	1195	1196	1197	1198	1199	1200	1201	1202	1203	1204	1205	1206	1207	1208	1209	1210	1211	1212	1213	1214	1215	1216	1217	1218	1219	1220	1221	1222	1223	1224	1225	1226	1227	1228	1229	1230	1231	1232	1233	1234	1235	1236	1237	1238	1239	1240	1241	1242	1243	1244	1245	1246	1247	1248	1249	1250	1251	1252	1253	1254	1255	1256	1257	1258	1259	1260	1261	1262	1263	1264	1265	1266	1267	1268	1269	1270	1271	1272	1273	1274	1275	1276	1277	1278	1279	1280	1281	1282	1283	1284	1285	1286	1287	1288	1289	1290	1291	1292	1293	1294	1295	1296	1297	1298	1299	1300	1301	1302	1303	1304	1305	1306	1307	1308	1309	1310	1311	1312	1313	1314	1315	1316	1317	1318	1319	1320	1321	1322	1323	1324	1325	1326	1327	1328	1329	1330	1331	1332	1333	1334	1335	1336	1337	1338	1339	1340	1341	1342	1343	1344	1345	1346	1347	1348	1349	1350	1351	1352	1353	1354	1355	1356	1357	1358	1359	1360	1361	1362	1363	1364	1365	1366	1367	1368	1369	1370	1371	1372	1373	1374	1375	1376	1377	1378	1379	1380	1381	1382	1383	1384	1385	1386	1387	1388	1389	1390	1391	1392	1393	1394	1395	1396	1397	1398	1399	1400	1401	1402	1403	1404	1405	1406	1407	1408	1409	1410	1411	1412	1413	1414	1415	1416	1417	1418	1419	1420	1421	1422	1423	1424	1425	1426	1427	1428	1429	1430	1431	1432	1433	1434	1435	1436	1437	1438	1439	1440	1441	1442	1443	1444	1445	1446	1447	1448	1449	1450	1451	1452	1453	1454	1455	1456	1457	1458	1459	1460	1461	1462	1463	1464	1465	1466	1467	1468	1469	1470	1471	1472	1473	1474	1475	147
---	---	---	---	---	---	---	---	---	----	----	----	----	----	----	----	----	----	----	----	----	----	----	----	----	----	----	----	----	----	----	----	----	----	----	----	----	----	----	----	----	----	----	----	----	----	----	----	----	----	----	----	----	----	----	----	----	----	----	----	----	----	----	----	----	----	----	----	----	----	----	----	----	----	----	----	----	----	----	----	----	----	----	----	----	----	----	----	----	----	----	----	----	----	----	----	----	----	----	-----	-----	-----	-----	-----	-----	-----	-----	-----	-----	-----	-----	-----	-----	-----	-----	-----	-----	-----	-----	-----	-----	-----	-----	-----	-----	-----	-----	-----	-----	-----	-----	-----	-----	-----	-----	-----	-----	-----	-----	-----	-----	-----	-----	-----	-----	-----	-----	-----	-----	-----	-----	-----	-----	-----	-----	-----	-----	-----	-----	-----	-----	-----	-----	-----	-----	-----	-----	-----	-----	-----	-----	-----	-----	-----	-----	-----	-----	-----	-----	-----	-----	-----	-----	-----	-----	-----	-----	-----	-----	-----	-----	-----	-----	-----	-----	-----	-----	-----	-----	-----	-----	-----	-----	-----	-----	-----	-----	-----	-----	-----	-----	-----	-----	-----	-----	-----	-----	-----	-----	-----	-----	-----	-----	-----	-----	-----	-----	-----	-----	-----	-----	-----	-----	-----	-----	-----	-----	-----	-----	-----	-----	-----	-----	-----	-----	-----	-----	-----	-----	-----	-----	-----	-----	-----	-----	-----	-----	-----	-----	-----	-----	-----	-----	-----	-----	-----	-----	-----	-----	-----	-----	-----	-----	-----	-----	-----	-----	-----	-----	-----	-----	-----	-----	-----	-----	-----	-----	-----	-----	-----	-----	-----	-----	-----	-----	-----	-----	-----	-----	-----	-----	-----	-----	-----	-----	-----	-----	-----	-----	-----	-----	-----	-----	-----	-----	-----	-----	-----	-----	-----	-----	-----	-----	-----	-----	-----	-----	-----	-----	-----	-----	-----	-----	-----	-----	-----	-----	-----	-----	-----	-----	-----	-----	-----	-----	-----	-----	-----	-----	-----	-----	-----	-----	-----	-----	-----	-----	-----	-----	-----	-----	-----	-----	-----	-----	-----	-----	-----	-----	-----	-----	-----	-----	-----	-----	-----	-----	-----	-----	-----	-----	-----	-----	-----	-----	-----	-----	-----	-----	-----	-----	-----	-----	-----	-----	-----	-----	-----	-----	-----	-----	-----	-----	-----	-----	-----	-----	-----	-----	-----	-----	-----	-----	-----	-----	-----	-----	-----	-----	-----	-----	-----	-----	-----	-----	-----	-----	-----	-----	-----	-----	-----	-----	-----	-----	-----	-----	-----	-----	-----	-----	-----	-----	-----	-----	-----	-----	-----	-----	-----	-----	-----	-----	-----	-----	-----	-----	-----	-----	-----	-----	-----	-----	-----	-----	-----	-----	-----	-----	-----	-----	-----	-----	-----	-----	-----	-----	-----	-----	-----	-----	-----	-----	-----	-----	-----	-----	-----	-----	-----	-----	-----	-----	-----	-----	-----	-----	-----	-----	-----	-----	-----	-----	-----	-----	-----	-----	-----	-----	-----	-----	-----	-----	-----	-----	-----	-----	-----	-----	-----	-----	-----	-----	-----	-----	-----	-----	-----	-----	-----	-----	-----	-----	-----	-----	-----	-----	-----	-----	-----	-----	-----	-----	-----	-----	-----	-----	-----	-----	-----	-----	-----	-----	-----	-----	-----	-----	-----	-----	-----	-----	-----	-----	-----	-----	-----	-----	-----	-----	-----	-----	-----	-----	-----	-----	-----	-----	-----	-----	-----	-----	-----	-----	-----	-----	-----	-----	-----	-----	-----	-----	-----	-----	-----	-----	-----	-----	-----	-----	-----	-----	-----	-----	-----	-----	-----	-----	-----	-----	-----	-----	-----	-----	-----	-----	-----	-----	-----	-----	-----	-----	-----	-----	-----	-----	-----	-----	-----	-----	-----	-----	-----	-----	-----	-----	-----	-----	-----	-----	-----	-----	-----	-----	-----	-----	-----	-----	-----	-----	-----	-----	-----	-----	-----	-----	-----	-----	-----	-----	-----	-----	-----	-----	-----	-----	-----	-----	-----	-----	-----	-----	-----	-----	-----	-----	-----	-----	-----	-----	-----	-----	-----	-----	-----	-----	-----	-----	-----	-----	-----	-----	-----	-----	-----	-----	-----	-----	-----	-----	-----	-----	-----	-----	-----	-----	-----	-----	-----	-----	-----	-----	-----	-----	-----	-----	-----	-----	-----	-----	-----	-----	-----	-----	-----	-----	-----	-----	-----	-----	-----	-----	-----	-----	-----	-----	-----	-----	-----	-----	-----	-----	-----	-----	-----	-----	-----	-----	-----	-----	-----	-----	-----	-----	-----	-----	-----	-----	-----	-----	-----	-----	-----	-----	-----	-----	-----	-----	-----	-----	-----	-----	-----	-----	-----	-----	-----	-----	-----	-----	-----	-----	-----	-----	-----	-----	-----	-----	-----	-----	-----	-----	-----	-----	-----	-----	-----	-----	-----	-----	-----	-----	-----	-----	-----	-----	-----	-----	-----	-----	-----	-----	-----	-----	-----	-----	-----	-----	-----	-----	-----	-----	-----	-----	-----	-----	-----	-----	-----	-----	-----	-----	-----	-----	-----	-----	-----	-----	-----	-----	-----	-----	-----	-----	-----	-----	-----	-----	-----	-----	-----	-----	-----	-----	-----	-----	-----	-----	-----	-----	-----	-----	-----	-----	-----	-----	-----	-----	-----	-----	-----	-----	-----	-----	-----	-----	-----	-----	-----	-----	-----	-----	-----	-----	-----	-----	-----	-----	-----	-----	-----	-----	-----	-----	-----	-----	-----	-----	-----	-----	-----	-----	-----	-----	-----	-----	-----	-----	-----	-----	-----	-----	-----	-----	-----	-----	-----	-----	-----	-----	-----	-----	-----	-----	-----	-----	-----	-----	-----	-----	-----	-----	-----	-----	-----	-----	-----	-----	-----	-----	-----	-----	-----	-----	-----	-----	-----	-----	-----	-----	-----	-----	-----	-----	-----	-----	-----	-----	-----	-----	-----	-----	-----	-----	-----	-----	-----	-----	-----	-----	-----	-----	-----	-----	-----	-----	-----	-----	-----	-----	-----	-----	-----	-----	-----	-----	-----	-----	-----	-----	-----	-----	-----	-----	-----	-----	-----	-----	-----	-----	------	------	------	------	------	------	------	------	------	------	------	------	------	------	------	------	------	------	------	------	------	------	------	------	------	------	------	------	------	------	------	------	------	------	------	------	------	------	------	------	------	------	------	------	------	------	------	------	------	------	------	------	------	------	------	------	------	------	------	------	------	------	------	------	------	------	------	------	------	------	------	------	------	------	------	------	------	------	------	------	------	------	------	------	------	------	------	------	------	------	------	------	------	------	------	------	------	------	------	------	------	------	------	------	------	------	------	------	------	------	------	------	------	------	------	------	------	------	------	------	------	------	------	------	------	------	------	------	------	------	------	------	------	------	------	------	------	------	------	------	------	------	------	------	------	------	------	------	------	------	------	------	------	------	------	------	------	------	------	------	------	------	------	------	------	------	------	------	------	------	------	------	------	------	------	------	------	------	------	------	------	------	------	------	------	------	------	------	------	------	------	------	------	------	------	------	------	------	------	------	------	------	------	------	------	------	------	------	------	------	------	------	------	------	------	------	------	------	------	------	------	------	------	------	------	------	------	------	------	------	------	------	------	------	------	------	------	------	------	------	------	------	------	------	------	------	------	------	------	------	------	------	------	------	------	------	------	------	------	------	------	------	------	------	------	------	------	------	------	------	------	------	------	------	------	------	------	------	------	------	------	------	------	------	------	------	------	------	------	------	------	------	------	------	------	------	------	------	------	------	------	------	------	------	------	------	------	------	------	------	------	------	------	------	------	------	------	------	------	------	------	------	------	------	------	------	------	------	------	------	------	------	------	------	------	------	------	------	------	------	------	------	------	------	------	------	------	------	------	------	------	------	------	------	------	------	------	------	------	------	------	------	------	------	------	------	------	------	------	------	------	------	------	------	------	------	------	------	------	------	------	------	------	------	------	------	------	------	------	------	------	------	------	------	------	------	------	------	------	------	------	------	------	------	------	------	------	------	------	------	------	------	------	------	------	------	------	------	------	------	------	------	------	------	------	------	------	------	------	------	------	------	------	------	------	------	------	------	------	------	------	------	------	------	------	------	------	------	------	------	------	------	------	------	------	------	------	------	------	------	------	------	------	------	------	------	------	------	------	------	------	------	------	------	------	------	-----

Ship's Regulations1. ALCOHOLIC BEVERAGES

The introduction, possession or use of alcoholic liquors for beverage purposes by any person on board MSTS ships is prohibited except:

- a. As authorized for medical purposes.
- b. As cargo properly sponsored and manifested by a shipper service.
- c. As authorized by Article 1269, U.S. Navy Regulations, subject to the following restrictions:

(1) Cabin class passengers destined for the CONUS are authorized to bring on board, for personal use ashore, not more than one U.S. wine quart of alcoholic liquor. Family units, accompanied or unaccompanied by the principal or sponsor, are limited to not more than 1 U.S. wine quart per family unit.

(2) Troop class passengers are not authorized to bring alcoholic liquor on board MSTS ships.

(3) Navy and/or civilian marine personnel assigned to MSTS ships are authorized to bring on board, for personal use ashore, not more than one U.S. wine quart of alcoholic liquor during each return voyage from a foreign port.

(4) The only exception to the above is that, when returning from the Virgin Islands, American Samoa or Guam, one gallon of alcoholic liquor may be brought on board.

(5) The person who brings alcoholic liquor on board shall file with the commanding officer/master a statement of the quantity and kind of alcoholic liquor brought on board by him, together with his certification that its importation will be in compliance with customs and internal revenue laws and regulations and applicable state or local laws at the place of debarkation.

(6) The person who brings alcoholic liquor on board will waive all claims against the Government for loss or breakage.

(7) Alcoholic liquors will be delivered to the custody of the commanding officer/master immediately upon embarkation, in sealed packages, securely packed and properly marked.

(8) Alcoholic liquor will be securely stored throughout the voyage and returned to individuals at the time of debarkation.

d. Transportation of alcoholic liquor for personal use ashore is also authorized from the CONUS or between ports outside the CONUS, subject to the above restrictions and provided that the individual complies with customs regulations at the foreign port of entry.

e. The foregoing is intended to provide practical limitations on the amount of alcoholic liquors individuals may bring aboard ship for personal use ashore. It does not ensure the importation of alcoholic liquors tax and duty free. Supplemental instructions concerning the collection, stowage and distribution of alcoholic liquors brought aboard ships by individuals will be promulgated by cognizant MSTS administrative commanders.

2. NARCOTICS AND NARCOTICS SUSPECTS

The introduction, possession, or use of narcotics or marijuana, or substances containing narcotics, or instruments which are used to administer, dispense or carry narcotics, except for authorized medical purposes or when transported as protected cargo properly manifested and securely stowed, is prohibited aboard MSTS ships by Article 1270, U.S. Navy Regulations. In addition, civilian marine personnel are subject to the provisions of Public Law 500, 83rd Congress (46 U.S. Code 239b) which specifically states that an original seaman's document may be denied to any applicant who, within ten years prior to the date of the application, has been convicted of a violation of the narcotic drug laws of the United States or of any state or territory; or, any applicant, who, unless he furnished satisfactory evidence that he is cured, has been a user or addicted to the use of a narcotic drug. The law also provides for a seaman's document to be revoked if the seaman, subsequent to 15 July 1954, is convicted of a violation of the narcotic drug laws of the United States or any state or territory.

a. Commanding officers/masters will take every possible precaution, including but not limited to the following, to prevent the smuggling of narcotics aboard ship:

(1) Prohibit foreign merchants from conducting sales of any nature to personnel aboard ship.

(2) Inspect all packages brought aboard at foreign ports.

(3) Post conspicuously, and bring frequently to the attention of all personnel, appropriate regulations.

(4) Conduct periodic surprise searches throughout the ship, especially after leaving a foreign port.

b. Appropriate disciplinary action will be taken against crew violators. Any passenger having narcotics in his possession, without proper authority, will be placed under arrest or such restraint as is deemed appropriate until he can be delivered to United States Federal authorities at the port of debarkation.

c. Unauthorized narcotics or instruments discovered aboard ship will be confiscated, marked for positive identification by witnesses, sealed and securely stored until turned over to proper authority. Containers of narcotics or instruments confiscated will be handled carefully to prevent marring of any finger prints.

d. Section 184a of Title 21, U. S. Code as amended, is quoted for information: (a) Whoever brings on board, or has in his possession or control on board any vessel of the United States, while engaged on a foreign voyage, any narcotic drug not constituting a part of the cargo entered in the manifest or part of the ship stores, shall be imprisoned not less than five or more than twenty years, and in addition, may be fined not more than \$20,000. For a second or subsequent offense (as determined under section 7237 (c) of the Internal Revenue Code of 1954), the offender shall be imprisoned not less than ten or more than forty years and, in addition, may be fined not more than \$20,000. For provisions relating to sentencing, probation, etc., See section 7237 (d) of the Internal Revenue Code 1954.

3. TIPPING

Solicitation of tips by crew members is prohibited. COMSTS policy is to render the best service possible to embarked passengers within available facilities aboard MSTs ships without necessitating the payment of gratuities therefor. Commanding officers/masters will assure maximum dissemination of this policy to assigned personnel and embarked passengers.

4. CONCESSIONS:

The conduct of any business in competition with the ship's store or MSTs exchange location, or solicitation of orders by crew personnel for merchandise of any nature and/or services aboard MSTs ships is prohibited. The commanding officer/master will ensure that all personnel are cognizant of this prohibition.

5. SMUGGLING:

There are heavy criminal penalties attached to smuggling and black-market activities at outports and in U. S. ports. Heavy fines may be levied against individuals and the resultant adverse publicity would bring discredit upon the Navy and MSTs. The commanding officer/master will establish and vigorously enforce positive measures to prevent the involvement of crew members in smuggling and black-marketeering. Disciplinary action will be taken against any crew member engaging in smuggling or black-market activities.

6. GAMBLING:

Gambling is prohibited aboard MSTs ships. The commanding officer/master shall ensure that regulations prohibiting gambling are posted conspicuously and shall take necessary lawful action to enforce compliance therewith by all personnel aboard. Funds seized in a gambling raid will be taken up by the disbursing officer/purser and credited to Treasury Account 171060, Forfeitures of Unclaimed Money and Property, in accordance with the NIF Handbook for MSTs.

7. PERSONAL WEAPONS

The unauthorized possession by any person aboard ship of a dangerous weapon is a criminal offense covered by Title 18, U. S. Code, Section 227 or,

if the weapon is a switch-blade knife, by USC 1243. Unauthorized weapons of passengers, unless voluntarily turned in by their owners, will be confiscated when discovered on board. Confiscated articles of passengers will be tagged with the names of owners and, when not required as evidence in connection with an unlawful act, turned over to the cognizant shipper service at the end of the voyage with request that appropriate disciplinary action be taken against individuals. In the case of civilian crew members, confiscated articles will be turned in to the cognizant LSTS commander with a report to assure that appropriate punitive action is taken.

a. Allowances of small arms and ammunition are provided for emergency purposes. Personnel responsible for the custody, maintenance, and use of small arms will be trained adequately in safety precautions and firing procedures.

b. The firing of weapons on board ships is prohibited when passengers are embarked, except in case of attempted robbery or for other warranted reason. The practice firing of small arms, during training exercises, is authorized provided passengers are not carried.

c. Weapons authorized to be in the possession of persons on board shall at all times be free of ammunition except as specifically authorized by the Commanding officer/master.

d. The commanding officer/master shall take appropriate action to ensure that all persons on board are aware of and comply with this regulation.

8. MASCOTS

Only with the express authority of the commanding officer/master may animal mascots be kept by assigned personnel aboard LSTS ships.

9. DRILLS INVOLVING PASSENGERS

The first drills conducted which involve passenger participation (fire collision, ABC defense, abandon ship, and others), shall always be announced in advance and the purposes and procedures carefully explained. These drills shall be conducted slowly so that each person thoroughly learns his part.

a. Announcing Drills. In announcing drills being conducted, the phrase "This is a drill" shall be used to avoid unnecessarily alarming passengers. When all necessary indoctrination drills have been properly conducted to the satisfaction of the master, there should be no forewarning of further drills, which should be conducted as expeditiously as is safely feasible.

b. Safeguarding Passengers. Depending upon the type of drill, special precautions shall be taken to safeguard passengers who, not being accustomed to ships, are subject to injury by automatic fire screen door closure, being trapped in closed spaces, or handling ship ports and heavy-dogged weather doors.

c. General Instructions for Drills. The following general instructions shall govern the conduct of drills:

(1) Emergency fire and abandon ship drills are segments of the overall damage control program. They may be conducted individually or as a part of and in conjunction with other damage control drills. Drills shall include rescue procedures and use of all rescue apparatus.

(2) All drills shall be made as realistic as possible and conducted as though an emergency actually existed. However, unnecessary hurry, rush, running and excitement, which might result in confusion and accidents, shall be avoided.

(3) Whenever possible, safety of the ship permitting, casualties will be simulated during drills.

(4) Whenever necessary to improve proficiency in drills, crew members shall be mustered either before or after drills and given appropriate instructions or practice.

(5) Drills shall be used as an opportunity to check on and improve readiness of crews and of emergency equipment under realistic conditions.

10. EMERGENCY, FIRE AND ABANDON SHIP DRILLS

The master shall conduct fire and abandon ship drills at least once in every week. Presailing and post-sailing drills prescribed below will meet this requirement:

a. Presailing Drills. When the voyage or voyage leg is to exceed one week in duration and passengers are to be carried, the master shall hold a presailing fire and abandon ship (boat) drill of the crew before the ship leaves port.

b. Post-sailing Drills. A post-sailing fire and abandon ship (boat) drill for indoctrination of passengers shall be held within 24 hours after departure from each port at which passengers have embarked. A regular fire and boat drill shall be held at least once each week thereafter.

c. Fire Drills. The following instructions will be observed in the conduct of emergency fire drills:

(1) All hands shall report to their assigned emergency stations and shall carry out their duties as specified in the station bill.

(2) Drills shall be scheduled to include below-deck areas in which fires are most likely to occur, i.e., paint and lamp lockers, galleys, storerooms, and machinery spaces. Smoke pots shall be used periodically for realism.

(3) All hand and power-operated watertight doors shall be closed.

(4) All fire screen doors shall be closed.

(5) Fire pumps shall be started and a sufficient number of outlets used to check the proper working order of the system. In addition, emergency fire pumps, when installed, shall also be operated under load for not less than 15 minutes during each drill. The diesel pumps and associated equipment will be inspected prior to, during, and after completion of each drill.

(6) Emergency diesel generators shall be operated under full load for not less than 5 minutes during each drill.

(7) All ventilation systems will be secured, including closing of air ports, securing vent covers, closing manual dampers, and all other ventilation closures. Where ventilation blowers must be reset individually only one zone will be secured during each drill, rotating the zones so that practice in securing all zones is provided.

(8) Scuppers, sanitary and other discharges which lead through the hull below the bulkhead deck, shall be closed.

(9) During each drill, damage control, rescue and safety equipment shall be brought from the damage control repair lockers and repair party personnel shall demonstrate their ability to use this equipment properly.

(10) Officers in charge of each zone area and damage control repair parties shall have a list of assigned crew members and shall assure that they are proficient in their emergency duties.

(11) Passengers shall be instructed to dress adequately, don and properly adjust lifejackets, and remain in their quarters until otherwise directed. Generally, passengers shall participate only in abandon ship drills. Steward department personnel shall be trained to instruct and direct passengers efficiently and courteously.

d. Abandon Ship Drills. The following instructions shall be observed in the conduct of abandon ship (boat) drills:

(1) Weather permitting, all lifesaving equipment shall be prepared for use.

(2) Boats shall be cleared away and swung out.

(3) Covers and strongbacks shall be removed. (Normally these are not used in MSTS ships except under snow and ice conditions.)

(4) Boat drains shall be closed.

(5) Embarkation ladders shall be secured in position.

(6) Sea painters shall be carried forward and tended to provide a good lead to hold the boats in position under the davits when in the water.

(7) Trapping lines shall be passed and tended. (Authorized trapping lines are equipped with shackles or sister hooks to prevent chaffing.)

(8) All gripes, lashings, pendants, trip-hooks, releasing gear, and propulsion gear shall be examined with due precaution to avoid accidental function and safety precautions.

(9) At least once each week during drills, the motor and hand-operated propelling gear of each lifeboat shall be operated (in both ahead and astern positions) for at least 5 Minutes.

(10) During drills in port, unobstructed boats shall be lowered to the water and their crews exercised in the use of oars, in the operation of the engine, or in the hand-propelling gear. This meets the USCG requirement for exercising each member of the crew (except females) in the use of oars at least once in three months.

(11) Although all lifeboats may not be used in a particular drill either in port or underway, the master shall ensure that each lifeboat is given occasional use (waterborne at least once in three months) to ascertain that gear is in good order and the crew is properly drilled.

(12) Each boat commander shall have a list of his crew and shall see that they are proficient in their duties.

(13) Passengers shall be instructed to dress adequately, don and properly adjust lifejackets, and report to their abandon ship stations during these drills.

(14) Standard commands, terminology, and procedures, specified in the MSTS Lifeboat Training Guide, shall be observed throughout.

11. STOWAWAYS

The commanding officer/master is responsible to ensure that every possible security measure is enforced to prevent the entry of a stowaway into the ship. A systematic and thorough search of the entire ship for stowaways shall be made prior to departure from every foreign port.

a. If a stowaway is discovered after the ship has put to sea and return of such individual can be effected without undue delay in schedule by debarkation into a small boat alongside, a message request for boat assistance will be made to appropriate port authorities.

b. If a stowaway is discovered after the ship has put to sea and it is impracticable to comply with a. above, every effort shall be made to return the individual to the port where illegal entry into the ship is considered to have been effected or to any other port of that country. In this connection, MSTS Ships will accept transfer of a stowaway from another MSTS ship to expedite return.

c. If return of a stowaway cannot be accomplished in accordance with a. and b. above, every effort will be made to debark such individual at the first port of call, consistent with the laws applicable to stowaways at that particular port.

d. A stowaway discovered aboard ship shall be placed under such custody and surveillance as required to ensure delivery to proper authorities. His nationality shall be determined and an affidavit, indicating the port where the individual is known to have stowed aboard, shall be prepared for delivery with the individual to proper authorities.

e. When a stowaway is discovered aboard, a message report shall be sent with information copies to the MSTS command at the port where the individual is known to have stowed aboard and the MSTS commander of the area in which the ship is operating.

f. If a stowaway is a member of the armed forces of the United States, he shall be delivered to proper military authorities ashore at the earliest opportunity.

g. The commanding officer/master lacks jurisdiction, in the absence of an empowering treaty, to apprehend a stowaway who escapes from MSTS custody in a foreign port. In the event a stowaway should escape, cognizant local authorities shall be notified immediately.

12. INSPECTION OF PASSENGER SPACES

It is a responsibility of the commanding officer/COMILDEPT to inspect, and assure the readiness of, all passenger spaces prior to embarkation. When passengers are embarked, the commanding officer/COMILDEPT shall assure that daily inspections are made of all spaces occupied by or assigned for the use of passengers.

a. While inspections of staterooms of cabin class passengers should be accomplished so as not to inconvenience occupants, it is imperative that the well-being of individuals in these spaces be ascertained each day. Failure of a cabin class passenger to appear for meals should be investigated immediately.

b. A daily inspection of troop spaces shall be conducted by the SUC. The commanding officer/master and COMILDEPT should designate such personnel as they deem appropriate to accompany the inspection party of the SUC.

c. In the interest of maintaining high standards of orderliness, cleanliness, and the elimination of fire hazards, voyage staff officers shall be required to conduct additional informal daily (including Sunday) inspections of troop spaces as are deemed appropriate. Conditions requiring corrective action should be reported immediately.

13. SANITARY INSPECTIONS

The ship's medical officer, accompanied by such personnel as are designated by the commanding officer/master and COMILDEPT, shall conduct daily sanitary inspections of the ship. Immediate action shall be taken to correct unsanitary conditions.

14. CUSTOMS

The commanding officer/master shall assist any proper examination by a customs officer of the United States aboard his ship. He shall not permit a foreign customs officer to make any examination on board.

a. Declaration and Entry of Crew Member for Imported Articles. Each crew member (military and civilian) will prepare a declaration (Customs Form 5123) for submission to the boarding U.S. Customs official at the port of entry upon arrival from foreign ports. Completed forms will be attached to the original of the Crew Purchase List.

b. Crew Purchase List of Articles Acquired in Foreign Countries. This list, which is a summarization of Customs Form(s) 5123 referred to above, must be prepared and submitted by the commanding officer/master to the U.S. Customs official at the port of entry upon arrival of a ship from foreign ports. All articles acquired in foreign countries by all members of the crew shall be listed. Articles listed should be segregated until formally passed by the boarding customs official. If there are no articles to be listed, the statement "Nothing to Declare" will suffice. One copy of Form 5123 for each crew member will be attached to the original copy of this list.

c. Declaration and Entry for Personal Baggage and Household Effects. For customs purposes, passengers (military and civilian) are divided into two main categories, i.e., those in the service of the United States and those not in the service of the United States.

(1) Army, Navy, and Air Force (military and civilian) personnel who return to the United States from overseas posts or stations under competent orders and members of their families who have resided with them at the overseas post or station are in the service of the United States.

(2) Red Cross workers, contract workers, and retired military personnel are not in the service of the United States.

(3) Under Public Law 126, 84th Congress, and the Customs Regulations issued thereunder, accompanied and unaccompanied baggage and household goods of personnel in the service of the United States may, subject to certain limitations and overseas inspection and documentation by "Inspecting Officers", be allowed duty and tax free entry into the United States. When an overseas "Inspecting Officer" certifies on DD Form 1252 (Owner's U. S. Customs Declaration and Entry and Inspecting Officer's Certificate) that accompanied or unaccompanied cabin or troop class baggage or household effects contain no prohibited or restricted articles, or articles in excess of quantities entitled to duty free entry under Public Law 126, and containers bear properly executed labels or tags DD Form 1253 (Customs Inspection of Household Goods and Personal Property Sticker) and DD Form 1253-1 (Customs Inspection of Household Goods and Personal Property Tag), such baggage or household goods will usually be passed at the U.S. port of entry without further inspection by the U.S. Customs or other U.S. Government agencies.

(4) In the event that baggage of personnel in the service of the United States is not pre-inspected abroad, Customs Form 6061 must be filed. The head of the family may file one completed Customs Form 6061 for the entire family.

(5) Since accompanied and unaccompanied baggage and household goods of personnel not in the service are not subject to the pre-embarkation inspection procedures, Customs Form 6063 must, in all cases, be filed by these personnel.

(6) Completed Customs Forms 6461, 6063, or DD Form 1252 will be given to the customs official who boards the ship. Each person or family unit shown on the passenger list shall be covered by one of these forms, as appropriate. Forms should be arranged in the same order as the names appear on the passenger list.

15. IMMIGRATION FORM I-94

Immigration will accept from each civilian passenger, citizen or alien, completed copies of Form I-94 to serve as a manifest. Citizen passengers need complete only the first four (4) lines of Form I-94. Alien passengers are required to complete the additional five (5) lines.

16. FRATERNIZATION between passengers and crew is prohibited.

17. GAME ISSUE ROOM

Location: Small Troop Recreation Room
Hours: 0900-1100

18. MOVIES: Hours of showings:

Ship's Officers: 1800 & 2030
Ship's Crew: 1700 & 2000
Military Dept: 1930
Cabin Class: 1800 & 2030
Troop Class: 1300, 1500, 1700 and 1900

19. EXCHANGE LOCATION HOURS OF OPERATION:

CABIN STORE: Monday thru Saturday: 0900-1130 & 1300-1600
Sundays & Holidays: 1300-1500
CLOSED AT ALL TIMES WHILE IN PORT

The Cabin Store is for all Cabin Class passengers, civilian crew members, and the Military Department assigned to this vessel.

TROOP STORE: Monday thru Saturday: 0900-1130 & 1300-1600
Sunday & Holidays: 1300-1500
CLOSED AT ALL TIMES WHILE IN PORT

BARBER SHOP: Hours of operation will be as directed by the Troop Sergeant Major and will be published in the Plan of the Day.

VENDING MACHINES: Normally will be in operation 24 hours a day. Any machine out of order should be reported to the exchange location operator. Anyone caught tampering with vending machines will be subject to disciplinary action.

20. MEDICAL & SICK CALL

Troop Screening: 0730 - by Troop Corpsmen in Small Recreation Room.

Troop Sick Call: 0800-1000 in Troop Examining Room.

Crew, MilDept, Cabin Passengers Sick Call: 0900-1000 in Crew Examining Room.

Sick Call will be held at these times only every day the ship is underway, with the exception of Sundays, and days leaving or entering port. Emergencies will be seen anytime.

21. LIBRARY: Located in Small Troop Recreation Room.
HOURS: 1100 - 2000

APPENDIX I
GLOSSARY OF NAUTICAL TERMS

ADRIFT	Loose, not secured to a stationary object
AFT-AFTER	To the rear, or rear of the ship
PASSAGEWAY	Hall
ATHWARTSHIPS	Crosswise of ship
BEAM	Over all width of ship
BOW	Front of ship
BRIG	Ship's prison
BULKHEAD	Wall or partition
BULKHEAD	Solid fence-like barrier along edges of weather deck
COMING	Raised partition to keep out water
DECK	Floor
FAIRTAIL	Rear end of the ship
FORE-FOREWARD	Front of the ship or to the front
GALLEY	Kitchen
GANGWAY	Portable walkway from the ship to the pier, also given as an order: "clear the way"
HEAD	Latrine, toilet
HOUSING	Outer walls of the ship's superstructure
LADDER	Stairs, stairway
OVERHEAD	Ceiling
PORT	Left side of ship looking forward
REEFER	Refrigerator
SCULLERY	Room or place for washing mess equipment
SCUTTLEBUTT	Drinking fountain, rumor
SICK BAY	Ship's hospital
SKIN	Hull of ship
STARBOARD	Right side of ship looking forward
STERN	Rear of ship

APPENDIX "J"

TROOP AREA CLEANING BILL

Suggested System for Cleaning Compartments

1. Clean all vents & exhaust blower screens.
2. A clean sweep down (under lockers and all corners, check overhead for candy wrappers, magazines, etc.)
3. Wash bulkheads, letting water run onto decks.
4. Scrub decks as per instructions.
5. Clean and polish any and all brass or stainless steel fittings (except fire-fighting equipment).
6. Have trash cans emptied and ready for inspection.
7. Return all cleaning equipment to designated gear lockers.
8. Keep all hands clear and stand-by for inspection.

Suggested System for Cleaning Latrines

1. A clean sweep down.
2. Wash all bulkheads & shower stalls, letting water run onto decks.
3. Wash toilet bowls inside and out, also toilet bowl seats, (underside and top using rubber gloves).
4. Clean urinals as per instructions.
5. Scrub decks as per instructions.
6. Replenish toilet paper.
7. Return cleaning equipment to designated gear lockers.
8. Stand-by for inspection.

Suggested System for Cleaning Ladderwells

1. A clean sweep down (including behind stair case).
2. Empty and wash all trash cans.
3. Start from top ladderwell and work down. Wash or scrub bulkheads as needed.
4. Wash staircase and surrounding areas as per instruction.
5. Mop-up, using clean water.
6. Return cleaning equipment to designated area.

DETAILED CLEANING INSTRUCTIONS

I All Troop Berthing Spaces shall be cleaned in the following manner:

Vents - A foxtail brush is provided in the list of cleaning equipment and should be used for maximum cleaning. If these vents accumulate dirt, less air will be provided, thus causing excess heat and stuffiness to exist.

Compt - These are magnasite (similar to cement) and are red in color.
Decks - These decks must be scrubbed, using liquid detergent in the scrub water, and then waxed and buffed. Excess water and streaks can be removed with clean mops.

- Compt Bulkheads - The bulkheads are to be washed daily with hot soapy water and rinsed off with clear water. Stubborn stains can be taken off with scouring powder. All brass fittings or stainless steel fittings, including water fountain should have a daily cleaning, using metal polish provided.
- Fire Fighting Equip. - Do not use anything but a hand wire brush for cleaning of fittings on this equipment.

II All Latrines shall be cleaned in the following manner:

- Decks - The white ceramic decks in the latrines should be scrubbed using stiff brushes and scouring powder. The hard-to-get area (behind commodes and in the corners) must be cleaned with rags and small brushes. Rinse thoroughly with clean water and disinfectant; use squeegees to push the excess water to the drains. If a general washdown is desired, use the black rubber hoses and connect them to the fire main system. Never use fire hoses. Remember this is salt water, and must be rinsed off afterwards with fresh water. The final step is to thoroughly dry the decks with clean mops.
- Urinals - These are made of stainless steel. The method of cleaning is simple.
1. Turn off water.
 2. Use wire brush to remove verdigris (salt water accumulation on the brass pipe fittings furnishing water) and other accumulation inside of urinal.
- Toilet Bowls -
1. All bowls are to be cleaned with toilet bowl cleaner which is provided in the list of cleaning equipment for latrines; a bowl brush will also be provided.
 2. Toilet bowl seats will be scrubbed daily with hot soapy water. The man detailed to this cleaning shall wear rubber gloves.
- Wash Basins -
1. All wash basins should be washed with hot soapy water and rinsed with clear water. Wipe dry with a clean cloth.
- Shower Stalls -
1. Shower stalls surrounding bulkheads and decks shall be washed as per instructions for latrine decks.

III Ladderwells and Passageways: All troop ladderwells and passageways shall be cleaned in the following manner.

- Decks - These are magnesite (similar to cement) and are red in color. These decks must be scrubbed, using liquid detergent in the scrub water, and then waxed and buffed. Excess water and streaks can be removed with clean mops.
- Bulk-heads - Ladderwells and surrounding bulkheads and steel decks are to be cleaned as per instructions in compartment cleaning, with the exception of the staircases, which are cleaned with HAND SCRUB BRUSHES, hot water and detergent.

IV Miscellaneous.

- Care of Mops - Using dirty mops to clean with is a waste of effort. Wash mops frequently. When through using, wash, squeeze dry and place in racks provided on the fantail, head up.
- Trash and GI Cans - Scrub after emptying, using disinfectant. Cans will be emptied in the garbage chute on the fantail and scrubbed out prior to returning to proper places.
- Water - Use fresh water only for cleaning purposes. Salt water will not thoroughly dissolve the various materials used.